

YUMO

I can start everything...
— 工控方案解决专家 —

ABS19系列金属按钮 Metal Buttons Switch Series



YUMO ELECTRIC



YUMO ELECTRIC

ABS19系列金属按钮 Metal Buttons Switch Series

YUMO

I can start everything...
— 工控方案解决专家 —

Φ19金属按钮开关 Metal Push Button Switch

ABS19S-P0



技术参数/Parameter

安装尺寸Diameter: Φ 19mm
开关额定值Switch Rating: 5A/250VAC
开关组合Contact Configuration: 1NO
操作类型Operation Type: 自复型Momentary
头部形状The Front Shape: 平面 Flat
外壳材料The Crust Material: 不锈钢Stainless steel/铜镀铬Copper plating
防护等级IP Degree: IP67, IK10

外形尺寸/Size

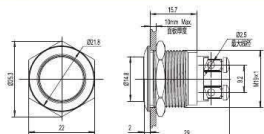

ABS19S-Q0



技术参数/Parameter

安装尺寸Diameter: Φ 19mm
开关额定值Switch Rating: 5A/250VAC
开关组合Contact Configuration: 1NO
操作类型Operation Type: 自复型Momentary
头部形状The Front Shape: 球面 Ball
外壳材料The Crust Material: 不锈钢Stainless steel/铜镀铬Copper plating
防护等级IP Degree: IP67, IK10

外形尺寸/Size

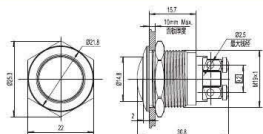

ABS19S-G0



技术参数/Parameter

安装尺寸Diameter: Φ 19mm
开关额定值Switch Rating: 5A/250VAC
开关组合Contact Configuration: 1NO
操作类型Operation Type: 自复型Momentary
头部形状The Front Shape: 高头 High
外壳材料The Crust Material: 不锈钢Stainless steel/铜镀铬Copper plating
防护等级IP Degree: IP67, IK10

外形尺寸/Size

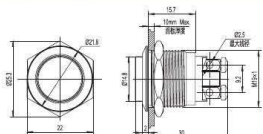

Φ19金属按钮开关 Metal Push Button Switch

ABS19S-P22



技术参数/Parameter

安装尺寸Diameter: Φ 19mm
开关额定值Switch Rating: 5A/250VAC
开关组合Contact Configuration: 1NO 1NC/2NO 2NC
操作类型Operation Type: 自复型Momentary/自锁型Maintained(Z)
头部形状The Front Shape: 平头 Flat
外壳材料The Crust Material: 不锈钢Stainless steel
防护等级IP Degree: IP67, IK10

外形尺寸/Size

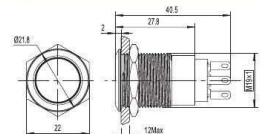

ABS19S-Q22



技术参数/Parameter

安装尺寸Diameter: Φ 19mm
开关额定值Switch Rating: 5A/250VAC
开关组合Contact Configuration: 1NO 1NC/2NO 2NC
操作类型Operation Type: 自复型Momentary/自锁型Maintained(Z)
头部形状The Front Shape: 球面 Ball
外壳材料The Crust Material: 不锈钢Stainless steel
防护等级IP Degree: IP67, IK10

外形尺寸/Size

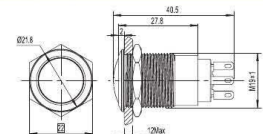

ABS19S-G22



技术参数/Parameter

安装尺寸Diameter: Φ 19mm
开关额定值Switch Rating: 5A/250VAC
开关组合Contact Configuration: 1NO 1NC/2NO 2NC
操作类型Operation Type: 自复型Momentary/自锁型Maintained(Z)
头部形状The Front Shape: 高头 High
外壳材料The Crust Material: 不锈钢Stainless steel
防护等级IP Degree: IP67, IK10

外形尺寸/Size

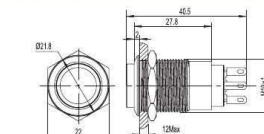

ABS19S-P1



技术参数/Parameter

安装尺寸Diameter: Φ 19mm
开关额定值Switch Rating: 5A/250VAC
开关组合Contact Configuration: 1NO
操作类型Operation Type: 自复型Momentary
头部形状The Front Shape: 平面 Flat
外壳材料The Crust Material: 不锈钢Stainless steel/铜镀铬Copper plating
防护等级IP Degree: IP67, IK10

外形尺寸/Size

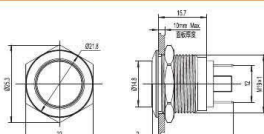

ABS19S-Q1



技术参数/Parameter

安装尺寸Diameter: Φ 19mm
开关额定值Switch Rating: 5A/250VAC
开关组合Contact Configuration: 1NO
操作类型Operation Type: 自复型Momentary
头部形状The Front Shape: 球面 Ball
外壳材料The Crust Material: 不锈钢Stainless steel/铜镀铬Copper plating
防护等级IP Degree: IP67, IK10

外形尺寸/Size

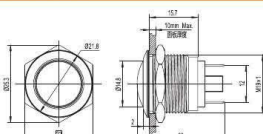

ABS19S-G1



技术参数/Parameter

安装尺寸Diameter: Φ 19mm
开关额定值Switch Rating: 5A/250VAC
开关组合Contact Configuration: 1NO
操作类型Operation Type: 自复型Momentary
头部形状The Front Shape: 高头 High
外壳材料The Crust Material: 不锈钢Stainless steel/铜镀铬Copper plating
防护等级IP Degree: IP67, IK10

外形尺寸/Size

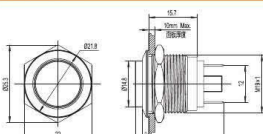

ABS19S-P11-E



技术参数/Parameter

安装尺寸Diameter: Φ 19mm
灯珠颜色Color: 红 R 黄 Y 绿 G 蓝 B 紫 P 白 W
开关额定值Switch Rating: 5A/250VAC
开关组合Contact Configuration: 1NO 1NC/2NO 2NC
操作类型Operation Type: 自复型Momentary/自锁型Maintained(Z)
带灯方式Lamp type: 环形带灯Ring Illuminated(LED)
外壳材料The Crust Material: 不锈钢Stainless steel/铜镀铬Copper plating
防护等级IP Degree: IP67, IK10

外形尺寸/Size

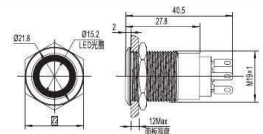

ABS19S-P11-D



技术参数/Parameter

安装尺寸Diameter: Φ 19mm
灯珠颜色Color: 红 R 黄 Y 绿 G 蓝 B 紫 P 白 W
开关额定值Switch Rating: 5A/250VAC
开关组合Contact Configuration: 1NO 1NC/2NO 2NC
操作类型Operation Type: 自复型Momentary/自锁型Maintained(Z)
带灯方式Lamp type: 单点带灯Dot Illuminated(LED)
外壳材料The Crust Material: 不锈钢Stainless steel
防护等级IP Degree: IP67, IK10

外形尺寸/Size

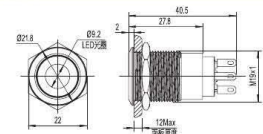

ABS19S-Q11-E



技术参数/Parameter

安装尺寸Diameter: Φ 19mm
灯珠颜色Color: 红 R 黄 Y 绿 G 蓝 B 紫 P 白 W
开关额定值Switch Rating: 5A/250VAC
开关组合Contact Configuration: 1NO 1NC/2NO 2NC
操作类型Operation Type: 自复型Momentary/自锁型Maintained(Z)
带灯方式Lamp type: 环形带灯Ring Illuminated(LED)
外壳材料The Crust Material: 不锈钢Stainless steel/铜镀铬Copper plating
防护等级IP Degree: IP67, IK10

外形尺寸/Size

