

Connect to the World

Founded in 1996, Weipu is one of the leading waterproof connector manufacturers in China. We have R&D professionals, up-to-date machinery, a fully equipped in-house testing lab and a customer-focused quality management system in accordance with ISO 9001. Weipu operates in compliance with the highest industry standards with certifications of RoHs, CE, CSA, and UL concerning quality, safety and sustainability.

Specialised in circular waterproof connectors, we offer push-pull, threaded and bayonet connectors, ranging from 3A to 400A, 2pin to 61pin, and IP44 to IP68, which can be applied to a wide variety of industrial applications operating in challenging environments.



Factory premises

Workshop building



In-house Test Lab Equipment

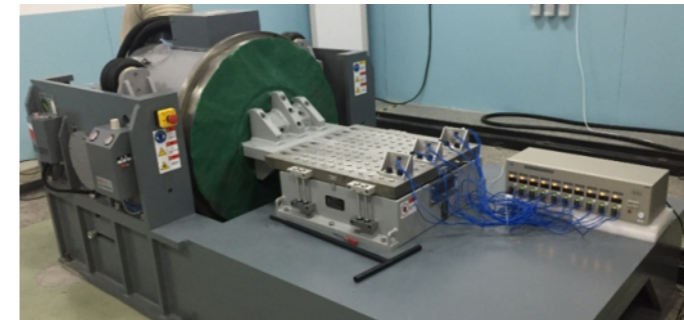

Vibration Test Equipment



Electric Current Break Test Equipment

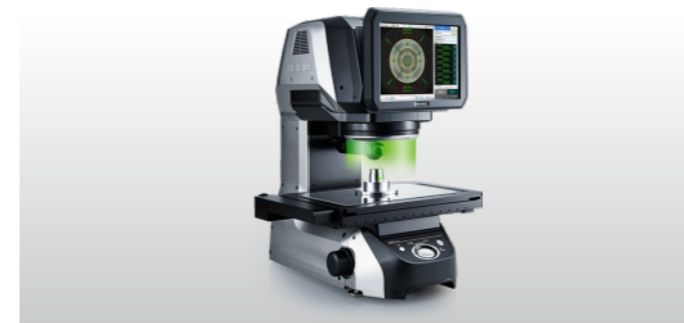

• Optical Comparator



Waterproof Ip Rating Test Chamber

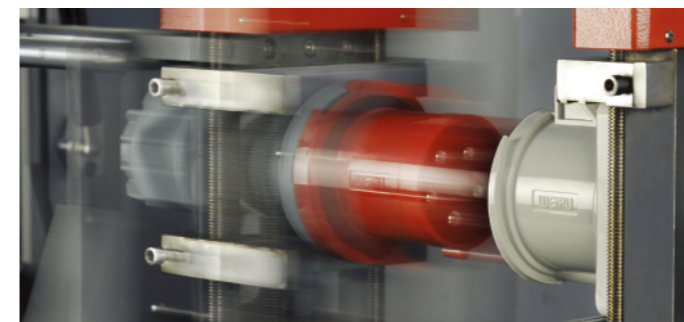

Mating Cycle Life Time Test Machine



Accurate Size Test Equipment



● WY Series

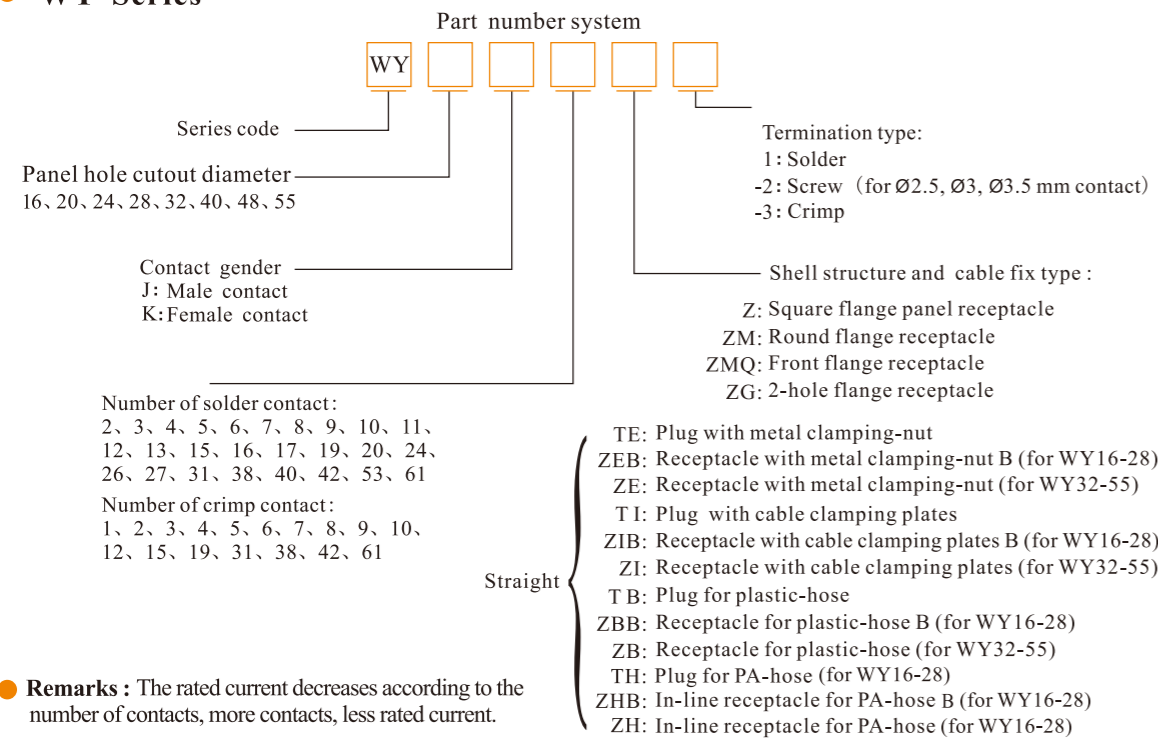

● **Remarks :** The rated current decreases according to the number of contacts, more contacts, less rated current.

Number of contact	1-3	4-10	11-20	21-30	31-40	41-50	51-61
Rated current decrease rate	0	10	20	30	40	50	60

Material and spec

Coupling	Bayonet		
Shell material	Zinc alloy with chrome plating		
Insert material	PPS, max temperature 260 °C		
Contact material	Brass with gold plating		
Termination	Solder: Ø1, Ø1.5, Ø2.5, Ø3.5, Ø5, 5mm;	Screw: Ø2.5, Ø3, Ø3.5mm;	Crimp: Ø1, Ø1.5, Ø2.5, Ø3.5, Ø5.5, Ø10mm
Mating cycle	500		
Temperature range	-40°C ~ +85°C		

★ Each side can be male or female contact ★ Crimp contact spec see P23/01-05
 ★ Solder contact spec see page P22/01-02 ★ Screw contact spec see P24/01-02

WY Series Mating diagram

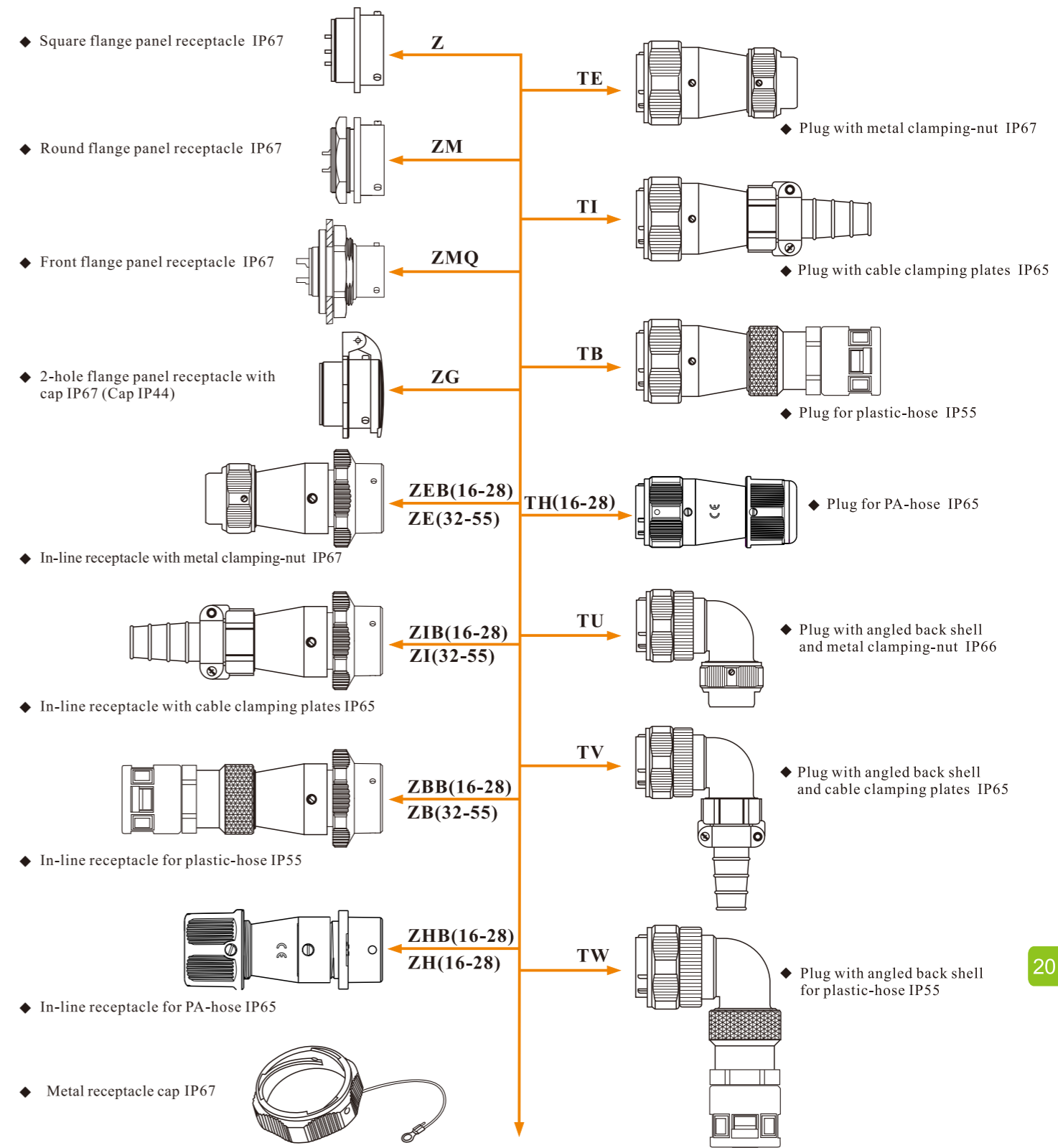

★ IP rating marked is for after mated or with cap. ★ Each side can be male or female contact ★ Crimp contact spec see P23/01-05
 ★ Solder contact spec see page P22/01-02 ★ Screw contact spec see P24/01-02



● Square flange panel receptacle: Z IP67

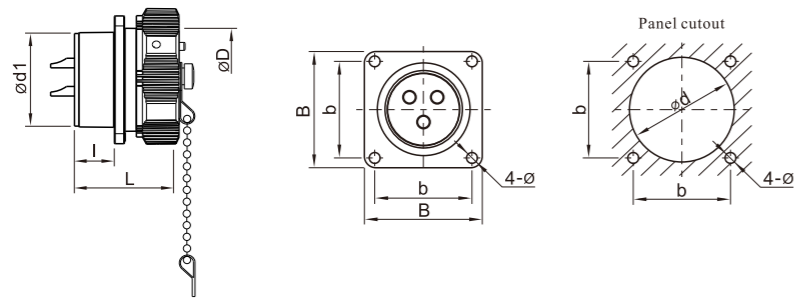

Dimension(mm)	WY16	WY20	WY24	WY28	WY32	WY40	WY48	WY55
d1	15.8	19.8	23.8	27.8	31.8	40	47.8	54.8
D	18	22	26	30	35	44	52	58
l	9.7	9.8	10	10	14.4	14.2	14.2	14
L	21.6	23	23	23	34	33.5	34	34
b	20	22	26	30	32	40	48	52
B	26	29	32	36	42	50	58	64
d	16.5	20.5	24.5	28.5	32.5	40.5	48.5	55.5
ø	3.2	3.2	3.2	3.2	3.5	4.5	4.5	4.5

● Round flange panel receptacle: ZM IP67

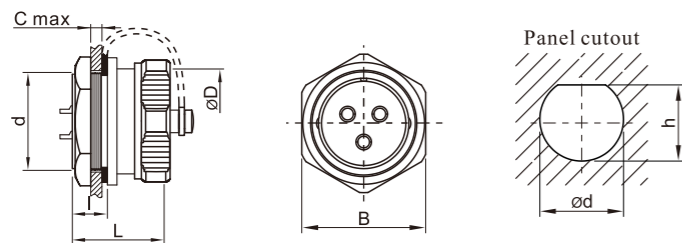

Dimension(mm)	WY16	WY20	WY24	WY28
d	M16X1	M20X1	M24X1	M28X1
D	18	22	26	30
C	5	5	5	5
l	9.7	9.9	10	10.2
L	22	23	23	23
B	21.2	25.5	29.2	33.3
ød	15.9	19.7	23.7	27.7
h	15.3	19.3	23.2	26.9

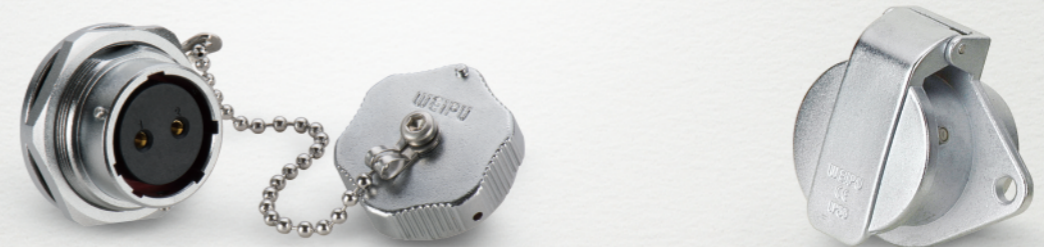

● Front-nut-mount receptacle: ZMQ IP67

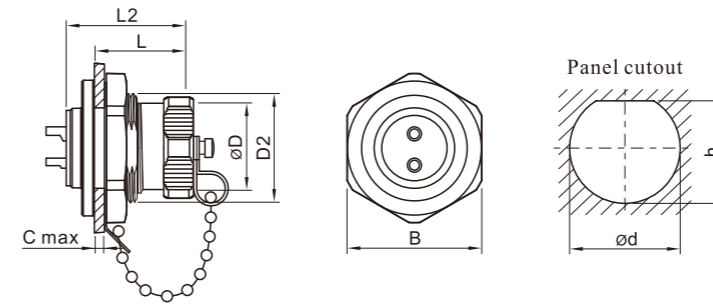

Dimension(mm)	WY16	WY20	WY24	WY28
D	18	22	26	30
D2	M22X1	M26X1	M30X1	M34X1
L	16	17	17	17
L2	21.6	23	23	23
C	5	5	5	5
B	26.8	30.8	34.8	38.8
ød	22	26	30	34
h	20.6	24.6	28.6	32.6

● 2-hole flange panel receptacle with cap: ZG IP67 (Cap IP44)

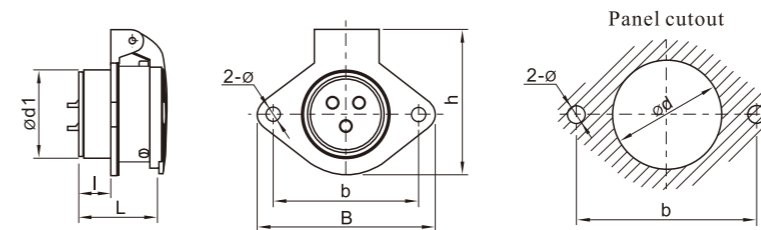

Dimension(mm)	WY16	WY20	WY24	WY28	WY32	WY40	WY48	WY55
d1	15.8	19.8	23.8	27.8	31.8	39.8	47.8	54.8
d	16.5	20.5	24.5	28.5	32.5	40.5	48.5	55.5
l	10	10	10	10	15.4	14.7	14.3	14
L	22	23	23	23	34	34	34	34
b	30	35	40	45	55	65	80	85
B	38	44	50	55	67	77	92	98
h	32.5	36.5	40.5	45.5	52.5	63.5	74.5	80
ø	3.5	4.5	4.5	4.5	5.5	5.5	5.5	6.5



● In-line receptacle with metal clamping-nut B: ZEB IP67

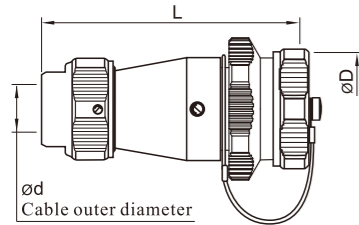

Dimension(mm)	WY16	WY20	WY24	WY28
D	18	22	26	30
L	55	63	66.5	70
ød	5-6.5	9-10.5	9-10.5	10.5-12.5

Optional cap size see P21-01

● In-line receptacle with metal clamping-nut: ZE IP67

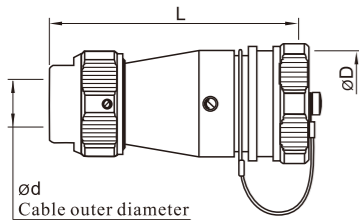

Dimension(mm)	WY32	WY40	WY48	WY55
D	35	44	52	58
L	90.5	103.5	108	131.6
ød	15.5-17	18-20	I:18-20 II: 24.5-26	24.5-26

Optional cap size see P21-01

● Plug with metal clamping-nut: TE IP67

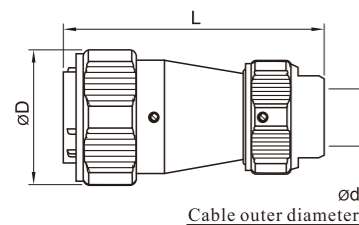

Dimension(mm)	WY16	WY20	WY24	WY28	WY32	WY40	WY48	WY55
D	25	29.5	34	38.5	44.5	54	62	68.5
L	54.5	62.5	65	68	88	100	110	131.5
ød	5-6.5	9-10.5	9-10.5	10.5-12.5	15.5-17	18-20	I:18-20 II: 24.5-26	24.5-26

20 ● Plug with angled back shell and metal clamping-nut: TU IP66

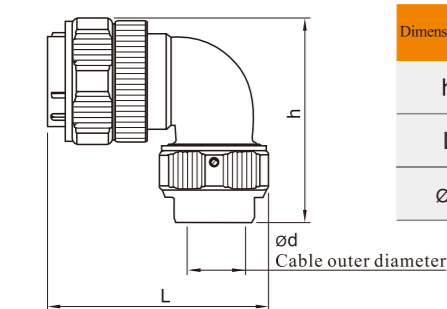

Dimension(mm)	WY16	WY20	WY24	WY28	WY32	WY40	WY48	WY55
h	43	53	54	58	72	88	103	110.5
L	48	57	59	61	84	90	97	109
ød	5-6.5	9-10.5	9-10.5	10.5-12.5	15.5-17	18-20	24.5-26	24.5-26



● In-line receptacle with cable clamping plates B: ZIB IP65

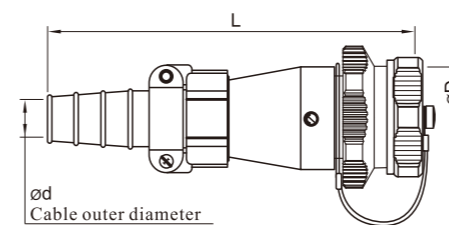

Dimension(mm)	WY16	WY20	WY24	WY28
D	18	22	26	30
L	73	88	92	101
ød	7-8	8-10.5	8-10.5	11.5-13.6

Optional cap size see P21-01

● In-line receptacle with cable clamping plates: ZI IP65

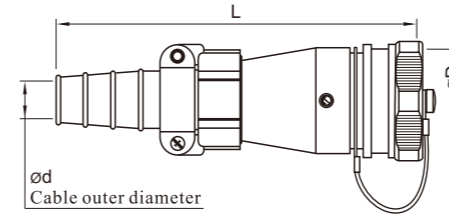

Dimension(mm)	WY32	WY40	WY48	WY55
D	35	44	52	58
L	119	130	137	165
ød	13-15.6	15.5-18.8	I:15.5-18.8 II: 24-28	24-28

Optional cap size see P21-01

● Plug with cable clamping plates: TI IP65

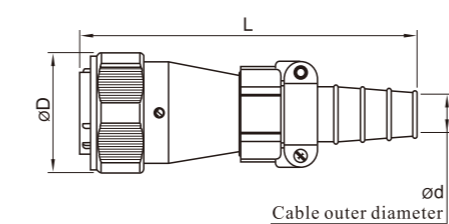

Dimension(mm)	WY16	WY20	WY24	WY28	WY32	WY40	WY48	WY55
D	25	29.5	34	38.5	44.5	54	62	68.5
L	72.5	87	92	100.5	48.5	130.5	140	163
ød	7-8	8-10.5	8-10.5	11.5-13.6	13-15.6	15.5-18.8	I:15.5-18.8 II: 24-28	24-28

● Plug with angled back shell and cable clamping plates: TV IP65

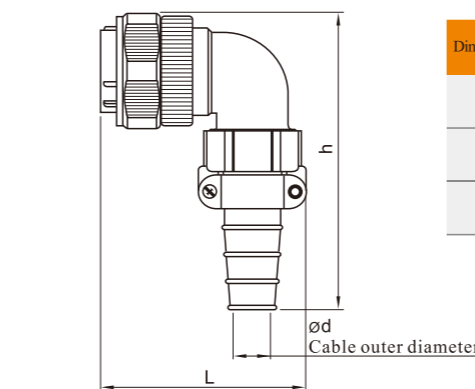

Dimension(mm)	WY16	WY20	WY24	WY28	WY32	WY40	WY48	WY55
h	60	80	80	93	103	118	137	140
L	49.5	56.5	58	61	82.5	90	98	108
ød	7-8	8-10.5	8-10.5	11.5-13.6	13-15.6	15.5-18.8	24-28	24-28



● In-line receptacle for plastic-hose B: ZBB IP55

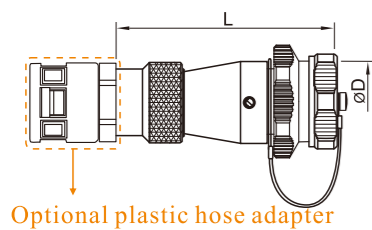

Dimension(mm)	WY16	WY20	WY24	WY28
D	18	22	26	30
L	54.5	64	67	73
Adapter size	PG7	PG11	PG11	PG16
model of plastic hose adapter	WQG-PG7(B)	WQG-PG11(B)	WQG-PG11(B)	WQG-PG16(B)
Hose size	AD10	AD15.8	AD15.8	AD21.2

Optional cap size see P21-01

● In-line receptacle for PA-hose: ZHB IP65

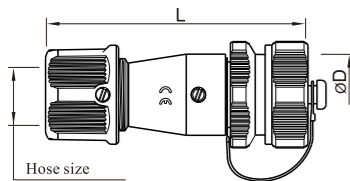

Dimension(mm)	WY16	WY20	WY24	WY28
D	18	22	26	30
L	52	62.5	66.5	70
Hose size	AD10	AD15.8	AD15.8	AD21.2

Optional cap size see P21-01

● In-line receptacle for plastic-hose: ZB IP55

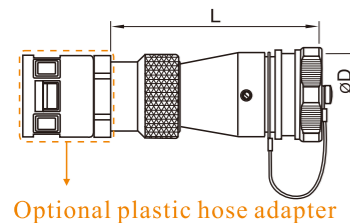

Dimension(mm)	WY32	WY40	WY48	WY55
D	35	44	52	58
L	86.5	95	104	120
Adapter size	PG21	PG29	I: PG29 II: PG36	PG36
model of plastic hose adapter	WQG-PG21(B)	WQG-PG29(B)	I: WQG-PG29(B) II: WQG-PG36(B)	WQG-PG36(B)
Hose size	AD28.5	AD34.5	I: AD34.5 II: AD42.5	AD42.5

Optional cap size see P21-01

● In-line receptacle for PA-hose : ZH P65

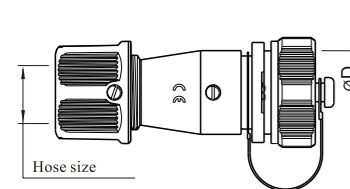

Dimension(mm)	WY16	WY20	WY24	WY28
D	18	22	26	30
L	54	64	66	70
Hose size	AD10	AD15.8	AD15.8	AD21.2

Optional cap size see P21-01



● Plug for plastic-hose: TB IP55

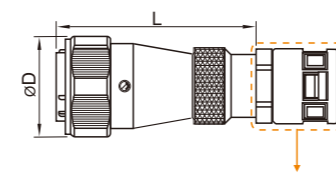

Optional plastic hose adapter

Dimension(mm)	WY16	WY20	WY24	WY28	WY32	WY40	WY48	WY55
D	25	29.5	34	38.5	44.5	54	91	96.5
L	54	62.5	66.5	72.5	87.5	95	105	118
Adapter size	PG7	PG11	PG11	PG16	PG21	PG29	I:PG29 II:PG36	PG36
model of plastic hose adapter	WQG-PG7(B)	WQG-PG11(B)	WQG-PG11(B)	WQG-PG16(B)	WQG-PG21(B)	WQG-PG29(B)	I:WQG-PG29(B) II:WQG-PG36(B)	WQG-PG36(B)
Hose size	AD10	AD15.8	AD15.8	AD21.2	AD28.5	AD34.5	I:AD34.5 II:AD42.5	AD42.5

● Plug for PA-hose: TH IP65

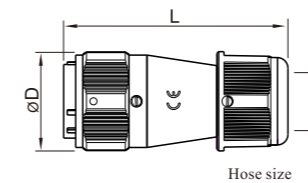

Dimension(mm)	WY16	WY20	WY24	WY28
D	25	29.6	34	38
L	51	62.5	65.5	68.5
Hose size	AD10	AD15.8	AD15.8	AD21.2

● Plug with angled back shell for plastic-hose: TW IP55

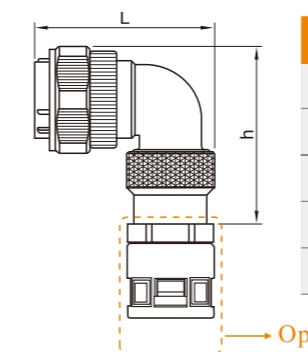

Optional plastic hose adapter

Dimension(mm)	WY16	WY20	WY24	WY28	WY32	WY40	WY48	WY55
h	44.5	53.5	55	61	70	83	91	96.5
L	47	56.5	57.5	61	82	88.5	95	106
Adapter size	PG7	PG11	PG11	PG16	PG21	PG29	PG29	PG36
model of plastic hose adapter	WQG-PG7(B)	WQG-PG11(B)	WQG-PG11(B)	WQG-PG16(B)	WQG-PG21(B)	WQG-PG29(B)	WQG-PG29(B)	WQG-PG36(B)
Hose size	AD10	AD15.8	AD15.8	AD21.2	AD28.5	AD34.5	AD42.5	AD42.5



● Plug with strain relief: TX IP67

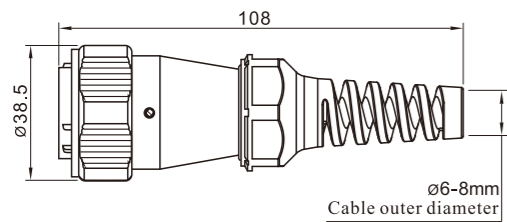

● In-line receptacle with strain relief B: ZXB IP67

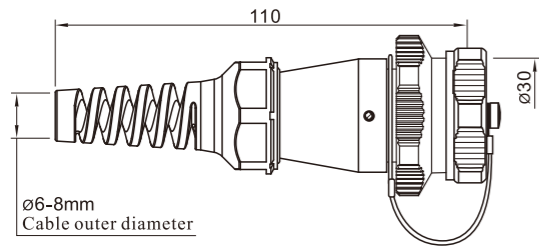

★ It can be produced 28 models, other models are customizable

Solder contact spec

★ Crimp contact spec see P23/01-05

★ Screw contact spec see P24/01-02

WY28	2	3	4	7	8	8B	9	10	10B	12	16	17	20	24	26	35
Male contact face view																
Rated current (A)	50	50	25	25	25	60, 5	25, 5	25	10	10	10	10	5	5	5	5
Contact diameter(mm)	3.5X2	3.5X3	2.5X4	2.5X7	2.5X8	5X2 1X6	2.5X4 1X5	2.5X10	1.5X10	1.5X12	1.5X16	1.5X17	1X20	1X24	1X26	1X35
Rated voltage (AC.V)	500	500	500	500	500	500 400	500	500	500	500	500	500	400	400	400	400
Test voltage(AC.V) 1 min	1500	1500	1500	1500	1500	1500	1500	1500	1500	1500	1500	1500	1200	1200	1200	1200
Contact resistance(mΩ)	0.5	0.5	1	1	1	0.5, 5	1, 5	1	2.5	2.5	2.5	2.5	5	5	5	5
Termination	solder / screw	solder / screw	solder / screw	solder / screw	solder / screw	solder	solder	solder / screw	solder	solder	solder	solder	solder	solder	solder	solder
Wire size (mm ² /AWG)	≤10/7	≤10/7	≤4/11	≤4/11	≤4/11	≤16/5 ≤0.75/18	≤4/11 ≤0.75/18	≤4/11	≤2/14	≤2/14	≤2/14	≤2/14	≤0.75/18	≤0.75/18	≤0.75/18	≤0.75/18
Wire size for screw termination	≤6/10	≤6/10	≤1.5/15	≤1.5/15	≤1.5/15	/	/	≤1.5/15	/	/	/	/	/	/	/	/



● PVC cable protection sleeve for WS series



Dimension(mm)	WS16	WS20	WS24	WS28	WS32	WS40	WS48	WS55
D	12.5	16	16.5	19	25	30	30	36
L	30	38	38	38	51	53	53	59
d	6	6	6	7	13	17.8	17.8	23

● IP67 Metal receptacle cover for WY series IP67

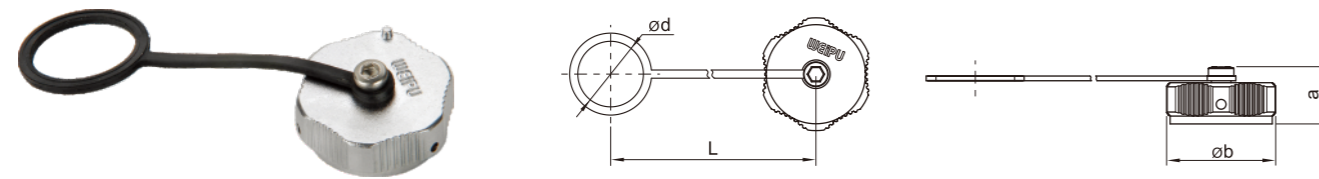

Dimension(mm)	WY16	WY20	WY24	WY28	WY32	WY40	WY48	WY55
a	13.5	14.5	14.5	14.5	17	17	17	17
b	20	29.5	34	38.5	44	54	62	68.5
d	16	20	24	28	32	40	48	55
L	55	60	65	70	90	100	110	120

● Plastic receptacle cover for WS and WF series

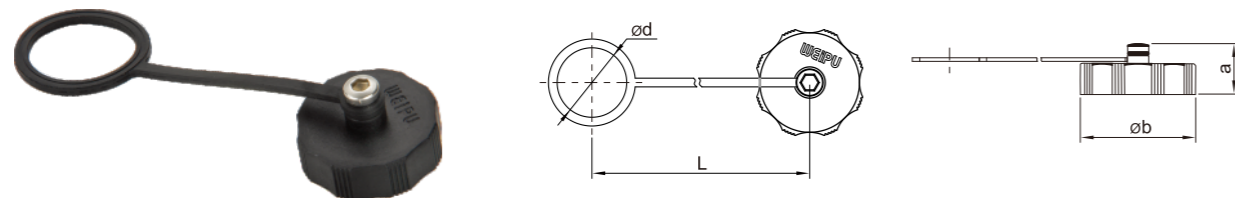

Dimension(mm)	WS/WF16	WS/WF20	WS/WF24	WS/WF28	WS/WF32	WS/WF40	WS/WF48	WS/WF55
a	14	14.5	14.5	14.5	20	20	20	20
b	21	26	29.5	34	39	48	55.5	62.5
d	16	20	24	28	32	40	48	55
L	55	60	65	70	90	100	110	120



● Metal hose adapter

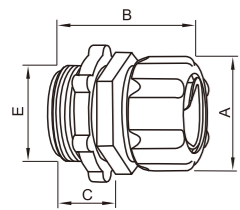

Part No.	WAB-16	WAB-20	WAB-24	WAB-30	WAB-36
Dimension(mm)					
A	19.6	24.8	29.1	35.7	41.8
B	26.7	33.3	37	37.9	41.5
C	9	14	15	16	17
E	16	20	24	30	36
hose size	1/4"	3/8"	1/2"	3/4"	1"
Thread	M16X1.5	M20X1.5	M24X1.5	M30X2	M36X2

● Angled metal hose adapter

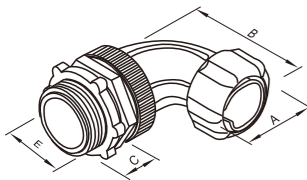

Part No.	WAL-20	WAL-24	WAL-30	WAL-36
Dimension(mm)				
A	24.8	29.1	35.7	41.8
B	48.5	53	59	70
C	14	15	16	17
E	20	24	30	36
管规 hose size	3/8"	1/2"	3/4"	1"
螺纹 Thread	M20X1.5	M24X1.5	M30X2	M36X2



● Junction-box

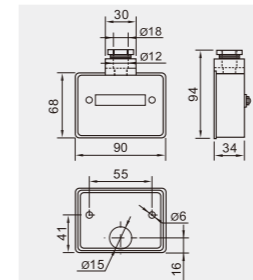

Rated A	Part No.TYP	Terminal P	Weight(g/pcs)
15A	6005	3P+⊕	120

Junction-box

Bottom hole
Upper hole (with cable tightening fittings)
Electric Inlet
Min conducting wire section mm² 1.5
Max conducting wire section mm² 4

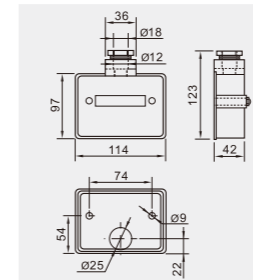

Rated A	Part No.TYP	Terminal P	Weight(g/pcs)
30A	6003	3P+N+⊕	230

Junction-box

Bottom hole
Upper hole (with cable tightening fittings)
Electric Inlet
Min conducting wire section mm² 2.5
Max conducting wire section mm² 10

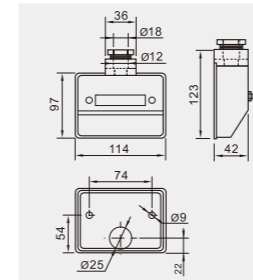

Rated A	Part No.TYP	Terminal P	Weight(g/pcs)
30A	6004	3P+N+⊕	200

Junction-box

Bottom hole
Upper hole (with cable tightening fittings)
Electric Inlet
Min conducting wire section mm² 2.5
Max conducting wire section mm² 10

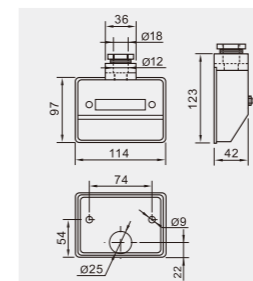

Rated A	Part No.TYP	Terminal P	Weight(g/pcs)
63A	6006	3P+N+⊕	248

Junction-box

Bottom hole
Upper hole (with cable tightening fittings)
Electric Inlet
Min conducting wire section mm² 10
Max conducting wire section mm² 25

Solder contact spec

WS16, WF16, WY16	2	3	4	2B	3B	4B	5	7	9	10
Male contact face view										
Rated current (A)	10	10	5	15	15	15	5	5	5	5
Contact diameter(mm)	Ø1.5X2	Ø1.5X3	Ø1X4	Ø2X2	Ø2X3	Ø2X4	Ø1X5	Ø1X7	Ø1X9	Ø1X10
Rated voltage (AC.V)	500	500	500	500	500	500	500	400	400	400
Test voltage(AC.V) 1 min	1500	1500	1500	1500	1500	1500	1500	1200	1200	1200
Contact resistance(mΩ)	2.5	2.5	5	2.5	2.5	2.5	5	5	5	5
Insulation resistance (MΩ)	2000	2000	2000	2000	2000	2000	2000	2000	2000	2000
Wire size(mm ² /AWG)	≤2/14	≤2/14	≤0.75/18	≤2/14	≤2/14	≤2/14	≤0.75/18	≤0.75/18	≤0.75/18	≤0.75/18

WS20, WF20, WY20	2	3	4	5	6	6B	7	8	9	12	15
Male contact face view											
Rated current (A)	25	25	25	10	5 25	5 30	10	10	5	5	5
Contact diameter(mm)	Ø2.5X2	Ø2.5X3	Ø2.5X4	Ø1.5X5	Ø1X2 Ø2.5X4	Ø1X4 Ø3X2	Ø1.5X7	Ø1.5X8	Ø1X9	Ø1X12	Ø1X15
Rated voltage (AC.V)	500	500	500	500	500	500	500	500	400	400	400
Test voltage(AC.V) 1 min	1500	1500	1500	1500	1500	1500	1500	1500	1200	1200	1200
Contact resistance(mΩ)	1	1	1	2.5	5 1	5 1	2.5	2.5	5	5	5
Insulation resistance (MΩ)	2000	2000	2000	2000	2000	2000	2000	2000	2000	2000	2000
Wire size(mm ² /AWG)	≤4/11	≤4/11	≤4/11	≤2/14	≤0.75/18 ≤4/11	≤0.75/18 ≤4/11	≤2/14	≤2/14	≤0.75/18	≤0.75/18	≤0.75/18

WS24, WF24, WY24	2	3	4	9	10	12	12B	19
Male contact face view								
Rated current (A)	25	25	25	5 25	10	10	5 30	5
Contact diameter(mm)	Ø2.5X2	Ø2.5X3	Ø2.5X4	Ø1X5 Ø2.5X4	Ø1.5X10	Ø1.5X12	Ø1X9 Ø3X3	Ø1X19
Rated voltage (AC.V)	500	500	500	500	500	500	500	400
Test voltage(AC.V) 1 min	1500	1500	1500	1500	1500	1500	1500	1200
Contact resistance(mΩ)	1	1	1	5 1	2.5	2.5	5 1	5
Insulation resistance (MΩ)	2000	2000	2000	2000	2000	2000	2000	2000
Wire size(mm ² /AWG)	≤4/11	≤4/11	≤4/11	≤0.75/18 ≤4/11	≤2/14	≤2/14	≤0.75/18 ≤4/11	≤0.75/18

WS28, WF28, WY28	2	3	4	7	8	8B	9	10	10B	12	16	17	20	24	26	35
Male contact face view																
Rated current (A)	50	50	25	25	25	60.5	25.5	25	10	10	10	10	5	5	5	5
Contact diameter(mm)	Ø3.5X2	Ø3.5X2	Ø2.5X4	Ø2.5X7	Ø2.5X8	Ø5X2 Ø1X6	Ø2.5X4 Ø1X5	Ø2.5X10	Ø1.5X10	Ø1.5X12	Ø1.5X16	Ø1.5X17	Ø1X20	Ø1X24	Ø1X26	Ø1X35
Rated voltage (AC.V)	500	500	500	500	500	500 400	500	500	500	500	500	500	400	400	400	400
Test voltage(AC.V) 1 min	1500	1500	1500	1500	1500	1500	1500	1500	1500	1500	1500	1500	1200	1200	1200	1200
Contact resistance(mΩ)	0.5	0.5	1	1	1	0.5, 5	1, 5	1	2.5	2.5	2.5	2.5	5	5	5	5
Insulation resistance (MΩ)	2000	2000	2000	2000	2000	2000	2000	2000	2000	2000	2000	2000	2000	2000	2000	2000
Wire size(mm ² /AWG)	≤10/7	≤10/7	≤4/11	≤4/11	≤4/11	≤16/6 ≤0.75/18	≤4/11 ≤0.75/18	≤4/11	≤2/14	≤2/14	≤2/14	≤2/14	≤0.75/18	≤0.75/18	≤0.75/18	≤0.75/18

Solder contact spec

WS32, WF32, WY32	4	6	8	8B	10	10B	11	12	13	19
Male contact face view										
Rated current (A)	50	10 50	10 50	10 50	10 25	25	25	25	10 25	10
Contact diameter(mm)	Ø3.5X4	Ø1.5X2 Ø3.5X4	Ø1.5X5 Ø3.5X3	Ø1.5X4 Ø3.5X4	Ø1.5X5 Ø2.5X5	Ø2.5X10	Ø2.5X11	Ø2.5X12	Ø1.5X9 Ø2.5X4	Ø1.5X19
Rated voltage (AC.V)	500V	500V	500V	500V	500V	500V	500V	500V	500V	500V
Test voltage(AC.V) 1 min	1500V	1500V	1500V	1500V	1500V	1500V	1500V	1500V	1500V	1500V
Contact resistance(mΩ)	0.5	2.5 0.5	2.5 0.5	2.5 0.5	2.5 1	1	1	1	2.5 1	2.5
Insulation resistance (MΩ)	2000	2000	2000	2000	2000	2000	2000	2000	2000	2000
Wire size(mm ² /AWG)	≤10/7	≤2/14 ≤10/7	≤2/14 ≤10/7	≤2/14 ≤10/7	≤2/14 ≤4/11	≤4/11	≤4/11	≤4/11	≤2/14 ≤4/11	≤2/14

WS40, WF40, WY40	5	9	15	26	31	52
Male contact face view						
Rated current (A)	50	25 50	10	10 25	10	5
Contact diameter(mm)	Ø3.5X5	Ø2.5X5 Ø3.5X4	Ø1.5X15	Ø1.5X22 Ø2.5X4	Ø1.5X31	Ø1X52
Rated voltage (AC.V)	500	500	500	500	500	400
Test voltage(AC.V) 1 min	1500	1500	1500	1500	1500	1200
Contact resistance(mΩ)	0.5	1 0.5	2.5	2.5, 1	2.5	5
Insulation resistance (MΩ)	2000	2000	2000	2000	2000	2000
Wire size(mm ² /AWG)	≤10/7	≤4/11 ≤10/7	≤2/14	≤2/14 ≤4/11	≤2/14	≤0.75/18

WS48, WF48, WY48	5	7	20	27	38	42
Male contact face view						
Rated current (A)	100	50	25	10 25	10 25	10
Contact diameter(mm)	Ø5.5X5	Ø3.5X7	Ø2.5X20	Ø1.5X26 Ø2.5X1	Ø1.5X33 Ø2.5X5	Ø1.5X42
Rated voltage (AC.V)	500	500	500	500	500	500
Test voltage(AC.V) 1 min	1500	1500	1500	1500	1500	1500
Contact resistance(mΩ)	0.3	0.5	1	2.5, 1	2.5, 1	2.5
Insulation resistance (MΩ)	2000	2000	2000	2000	2000	2000
Wire size(mm ² /AWG)	≤25/3	≤10/7	≤4/11	≤2/14 ≤4/11	≤2/14 ≤4/11	≤2/14

WS55, WF55, WY55	4	7	40	53	61
Male contact face view					
Rated current (A)	50 150	50 100	10 25	10 25	10
Contact diameter(mm)	Ø3.5X1 Ø10X3	Ø3.5X1 Ø5.5X6	Ø1.5X25 Ø2.5X15	Ø1.5X48 Ø2.5X5	Ø1.5X61
Rated voltage (AC.V)	500	500	500	500	500
Test voltage(AC.V) 1 min	1500	1500	1500	1500	1500
Contact resistance(mΩ)	0.5 0.2	0.5 0.3	2.5 1	2.5 1	2.5
Insulation resistance (MΩ)	2000	2000	2000	2000	2000
Wire size(mm ² /AWG)	≤10/7 ≤70/(2/0)	≤10/7 ≤25/3	≤2/14 ≤4/11	≤2/14 ≤4/11	≤2/14

Crimp contact spec

SF16, SA16, SP17, SY17 WS16, WF16, WY16	2	3	4
Male contact face view			
Rated current (A)	10	10	5
Contact diameter(mm)	Ø1.5X2	Ø1.5X3	Ø1X4
Rated voltage (AC.V)	500	500	400
Test voltage(AC.V) 1 min	1500	1500	1200
Contact resistance(mΩ)	2.5	2.5	5
Insulation resistance (MΩ)	2000	2000	2000

SF20, SA20, SP21, SY21 WS20,WF20, WY20, WP20	2	3	4	5	7	7B	8
Male contact face view							
Rated current (A)	25	25	25	10	10	5	5
Contact diameter(mm)	Ø2.5X2	Ø2.5X3	Ø2.5X4	Ø1.5X5	Ø1.5X7	Ø1X7	Ø1X8
Rated voltage (AC.V)	500	500	500	500	500	400	400
Test voltage(AC.V) 1 min	1500	1500	1500	1500	1500	1200	1200
Contact resistance(mΩ)	1	1	1	2.5	2.5	5	5
Insulation resistance (MΩ)	2000	2000	2000	2000	2000	2000	2000

WS24, WF24, WY24	4	5	9	12
Male contact face view				
Rated current (A)	25	25	10	5
Contact diameter(mm)	Ø2.5X4	Ø2.5X5	Ø1.5X9	Ø1X12
Rated voltage (AC.V)	500	500	500	400
Test voltage(AC.V) 1 min	1500	1500	1500	1200
Contact resistance(mΩ)	1	1	2.5	5
Insulation resistance (MΩ)	2000	2000	2000	2000

SA28, SP29, SY29 WS28, WF28, WY28	2	3	7	12	15	19
Male contact face view						
Rated current (A)	50	50	25	10	5	5
Contact diameter(mm)	Ø3.5X2	Ø3.5X3	Ø2.5X7	Ø1.5X12	Ø1X15	Ø1X19
Rated voltage (AC.V)	500	500	500	500	400	400
Test voltage(AC.V) 1 min	1500	1500	1500	1500	1200	1200
Contact resistance(mΩ)	0.5	0.5	1	2.5	5	5
Insulation resistance (MΩ)	2000	2000	2000	2000	2000	2000

Crimp contact spec

WS32, WF32, WY32	4	6	10	15	19
Male contact face view					
Rated current (A)	50	50 10	25	10	10
Contact diameter(mm)	Ø3.5X4	Ø3.5X4 Ø1.5X2	Ø2.5X10	Ø1.5X15	Ø1.5X19
Rated voltage (AC.V)	500	500	500	500	500
Test voltage(AC.V) 1 min	1500	1500	1500	1500	1500
Contact resistance(mΩ)	0.5	0.5 2.5	1	2.5	2.5
Insulation resistance (MΩ)	2000	2000	2000	2000	2000

WS40, WF40, WY40	5	19	31
Male contact face view			
Rated current (A)	50	25	10
Contact diameter(mm)	Ø3.5X5	Ø2.5X19	Ø1.5X31
Rated voltage (AC.V)	500	500	500
Test voltage(AC.V) 1 min	1500	1500	1500
Contact resistance(mΩ)	0.5	1	2.5
Insulation resistance (MΩ)	2000	2000	2000

WS48, WF48, WY48	31	42
Male contact face view		
Rated current (A)	25	10
Contact diameter(mm)	Ø2.5X31	Ø1.5X42
Rated voltage (AC.V)	500	500
Test voltage(AC.V) 1 min	1500	1500
Contact resistance(mΩ)	1	2.5
Insulation resistance (MΩ)	2000	2000

WS55, WF55, WY55	38	61
Male contact face view		
Rated current (A)	25	10
Contact diameter(mm)	Ø2.5X38	Ø1.5X61
Rated voltage (AC.V)	500	500
Test voltage(AC.V) 1 min	1500	1500
Contact resistance(mΩ)	1	2.5
Insulation resistance (MΩ)	2000	2000

Crimp contact

5A Crimp contact

- ※ Contact diameter: $\varnothing 1$
- ※ Material: Brass with gold plating
- ※ Contact resistance: 5m Ω

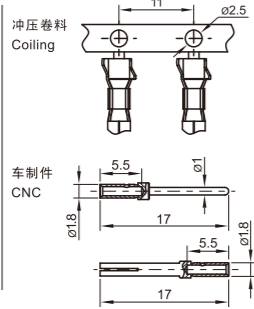

5A Male crimp contact For SF, SA, SP, SY, WP, WS/WF/WY16-28

Wire size	Stripping length	Male crimp contact p/n	Crimping tool p/n	Removal tool p/n
0.20-0.52mm ² AWG 24-20	5.5mm	Parting: YJ1-17-0.52AU-C Die: YJ1-17-0.52AU	CT-P20/28	RT-1.0

5A Female crimp contact For SF, SA, SP, SY, WP, WS/WF/WY16-28

Wire size	Stripping length	Female crimp contact p/n	Crimping tool p/n	Removal tool p/n
0.20-0.52mm ² AWG 24-20	5.5mm	Parting: YK1-17-0.52AU-C Die: YK1-17-0.52AU	CT-P20/28	RT-1.0

10A Crimp contact

- ※ Contact diameter: $\varnothing 1.5$
- ※ Material: Brass with gold plating
- ※ Contact resistance: 2.5m Ω

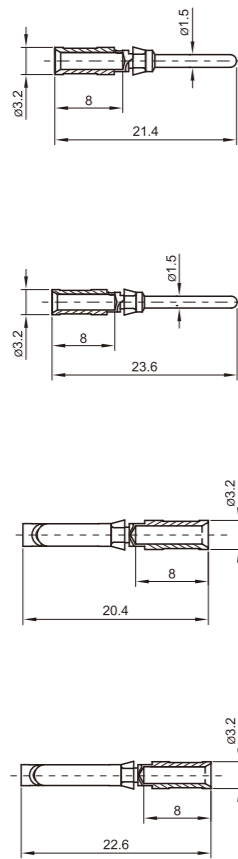

10A Male crimp contact For SF, SA, SP, SY, WP, WS/WF/WY16-28

Wire size	Stripping length	Male crimp contact p/n	Crimping tool p/n	Removal tool p/n
0.14-0.37mm ² AWG 26-22	8mm	YJ1.5-21.4-0.37AU	CT-P20/28	RT-1.5
0.5mm ² AWG 20	8mm	YJ1.5-21.4-0.5AU	CT-P20/28	RT-1.5
0.75-1.0mm ² AWG 18	8mm	YJ1.5-21.4-1.0AU	CTW-0.14/4	RT-1.5
1.5mm ² AWG 16	8mm	YJ1.5-21.4-1.5AU	CTW-0.14/4	RT-1.5
2.5mm ² AWG 14	8mm	YJ1.5-21.4-2.5AU	CTW-0.14/4	RT-1.5

10A Male crimp contact For WS/WF/WY32-55

Wire size	Stripping length	Male crimp contact p/n	Crimping tool p/n	Removal tool p/n
0.14-0.37mm ² AWG 26-22	8mm	YJ1.5-23.6-0.37AU	CT-P20/28	RT-1.5
0.5mm ² AWG 20	8mm	YJ1.5-23.6-0.5AU	CT-P20/28	RT-1.5
0.75-1.0mm ² AWG 18	8mm	YJ1.5-23.6-1.0AU	CTW-0.14/4	RT-1.5
1.5mm ² AWG 16	8mm	YJ1.5-23.6-1.5AU	CTW-0.14/4	RT-1.5
2.5mm ² AWG 14	8mm	YJ1.5-23.6-2.5AU	CTW-0.14/4	RT-1.5

10A Female crimp contact For SF, SA, SP, SY, WP, WS/WF/WY16-28

Wire size	Stripping length	Female crimp contact p/n	Crimping tool p/n	Removal tool p/n
0.14-0.37mm ² AWG 26-22	8mm	YK1.5-20.4-0.37AU	CT-P20/28	RT-1.5
0.5mm ² AWG 20	8mm	YK1.5-20.4-0.5AU	CT-P20/28	RT-1.5
0.75-1.0mm ² AWG 18	8mm	YK1.5-20.4-1.0AU	CTW-0.14/4	RT-1.5
1.5mm ² AWG 16	8mm	YK1.5-20.4-1.5AU	CTW-0.14/4	RT-1.5
2.5mm ² AWG 14	8mm	YK1.5-20.4-2.5AU	CTW-0.14/4	RT-1.5

10A Female crimp contact For WS/WF/WY32-55

Wire size	Stripping length	Female crimp contact p/n	Crimping tool p/n	Removal tool p/n
0.14-0.37mm ² AWG 26-22	8mm	YK1.5-22.6-0.37AU	CT-P20/28	RT-1.5
0.5mm ² AWG 20	8mm	YK1.5-22.6-0.5AU	CT-P20/28	RT-1.5
0.75-1.0mm ² AWG 18	8mm	YK1.5-22.6-1.0AU	CTW-0.14/4	RT-1.5
1.5mm ² AWG 16	8mm	YK1.5-22.6-1.5AU	CTW-0.14/4	RT-1.5
2.5mm ² AWG 14	8mm	YK1.5-22.6-2.5AU	CTW-0.14/4	RT-1.5

25A Crimp contact

- ※ Contact diameter: $\varnothing 2.5$
- ※ Material: Brass with gold plating
- ※ Contact resistance: 1m Ω

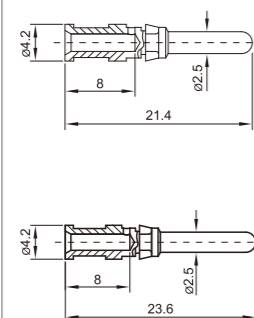

25A Male crimp contact For SF, SA, SP, SY, WP, WS/WF/WY16-28

Wire size	Stripping length	Male crimp contact p/n	Crimping tool p/n	Removal tool p/n
0.75-1.0mm ² AWG 18	8mm	YJ2.5-21.4-1.0AU	CTW-0.14/4	RT-2.5
1.5mm ² AWG 16	8mm	YJ2.5-21.4-1.5AU	CTW-0.14/4	RT-2.5
2.5mm ² AWG 14	8mm	YJ2.5-21.4-2.5AU	CTW-0.14/4	RT-2.5
4.0mm ² AWG 12	8mm	YJ2.5-21.4-4.0AU	CTW-0.14/4 CT-4/10	RT-2.5

25A Male crimp contact For WS/WF/WY32-55

Wire size	Stripping length	Male crimp contact p/n	Crimping tool p/n	Removal tool p/n
0.75-1.0mm ² AWG 18	8mm	YJ2.5-23.6-1.0AU	CTW-0.14/4	RT-2.5
1.5mm ² AWG 16	8mm	YJ2.5-23.6-1.5AU	CTW-0.14/4	RT-2.5
2.5mm ² AWG 14	8mm	YJ2.5-23.6-2.5AU	CTW-0.14/4	RT-2.5
4.0mm ² AWG 12	8mm	YJ2.5-23.6-4.0AU	CTW-0.14/4 CT-4/10	RT-2.5

Crimp contact

25A Crimp contact

- ※ Contact diameter: $\varnothing 2.5$
- ※ Material: Brass with gold plating
- ※ Contact resistance: 1m Ω

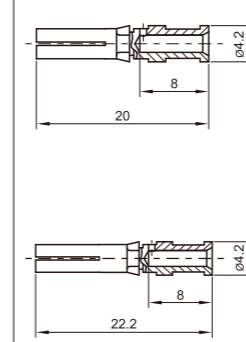

25A Female crimp contact For SF, SA, SP, SY, WP, WS/WF/WY16-28

Wire size	Stripping length	Female crimp contact p/n	Crimping tool p/n	Removal tool p/n
0.75-1.0mm ² AWG 18	8mm	YK2.5-20-1.0AU	CTW-0.14/4	RT-2.5
1.5mm ² AWG 16	8mm	YK2.5-20-1.5AU	CTW-0.14/4	RT-2.5
2.5mm ² AWG 14	8mm	YK2.5-20-2.5AU	CTW-0.14/4	RT-2.5
4.0mm ² AWG 12	8mm	YK2.5-20-4.0AU	CTW-0.14/4 CT-4/10	RT-2.5

25A Female crimp contact For WS/WF/WY32-55

Wire size	Stripping length	Female crimp contact p/n	Crimping tool p/n	Removal tool p/n
0.75-1.0mm ² AWG 18	8mm	YK2.5-22.2-1.0AU	CTW-0.14/4	RT-2.5
1.5mm ² AWG 16	8mm	YK2.5-22.2-1.5AU	CTW-0.14/4	RT-2.5
2.5mm ² AWG 14	8mm	YK2.5-22.2-2.5AU	CTW-0.14/4	RT-2.5
4.0mm ² AWG 12	8mm	YK2.5-22.2-4.0AU	CTW-0.14/4 CT-4/10	RT-2.5

50A Crimp contact

- ※ Contact diameter: $\varnothing 3.5$
- ※ Material: copper
- ※ Contact resistance: 0.5m Ω

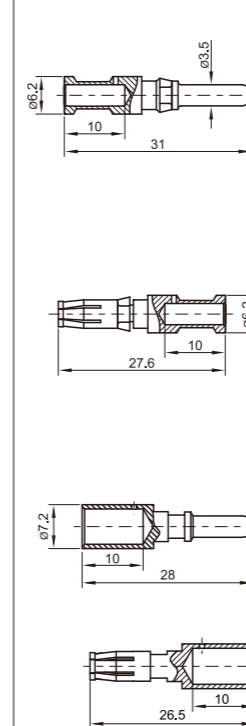

50A Male crimp contact For WS/WF/WY32-55

Wire size	Stripping length	Male crimp contact p/n	Crimping tool p/n	Removal tool p/n
1.5mm ² AWG 16	10mm	YJ3.5-31-1.5AU	CTW-0.14/4	RT-3.5
2.5mm ² AWG 14	10mm	YJ3.5-31-2.5AU	CTW-0.14/4	RT-3.5
4.0mm ² AWG 12	10mm	YJ3.5-31-4.0AU	CTW-0.14/4 CT-4/10	RT-3.5
6.0mm ² AWG 10	10mm	YJ3.5-31-6.0AU	CT-4/10	RT-3.5
10.0mm ² AWG 7	10mm	YJ3.5-31-10.0AU	CT-4/10	RT-3.5

50A Female crimp contact For WS/WF/WY32-55

Wire size	Stripping length	Female crimp contact p/n	Crimping tool p/n	Removal tool p/n
1.5mm ² AWG 16	10mm	YK3.5-27.6-1.5AU	CTW-0.14/4	RT-3.5
2.5mm ² AWG 14	10mm	YK3.5-27.6-2.5AU	CTW-0.14/4	RT-3.5
4.0mm ² AWG 12	10mm	YK3.5-27.6-4.0AU	CTW-0.14/4 CT-4/10	RT-3.5
6.0mm ² AWG 10	10mm	YK3.5-27.6-6.0AU	CT-4/10	RT-3.5
10.0mm ² AWG 7	10mm	YK3.5-27.6-10.0AU	CT-4/10	RT-3.5

50A Male crimp contact p/n For SP29, SY29, WS/WF/WY28 2 and 3 pins

Wire size	Stripping length	Male crimp contact p/n	Crimping tool p/n	Removal tool p/n
10mm ² AWG 7	10mm	YJ3.5-28-10.0AU	CT-4/10	RT-3.5
16mm ² AWG 5	10mm	YJ3.5-28-16.0AU	CT-4/10	RT-3.5

50A Female crimp contact For SP29, SY29, WS/WF/WY28 2 and 3 pins

Wire size	Stripping length	Female crimp contact p/n	Crimping tool p/n	Removal tool p/n
10mm ² AWG 7	10mm	YK3.5-26.5-10.0AU	CT-4/10	RT-3.5
16mm ² AWG 5	10mm	YK3.5-26.5-16.0AU	CT-4/10	RT-3.5

Crimping tool and Removal tool

Crimping tool

For crimping the male / female contacts



Part number	Crimping wire range
CT-P20/28	0.08-0.52mm ² AWG 28-20
CTW-0.14/4	0.14-4mm ² AWG 25-11
CT-4/10	4-10mm ² AWG 11-7

Removal tool

For taking out male / female contacts



Part number	Removal range
RT-1.0	5A Male / Female crimp contact
RT-1.5	10A Male / Female crimp contact
RT-2.5	25A Male / Female crimp contact
RT-3.5	50A Male / Female crimp contact

Crimp contact

50A Crimp contact

Contact diameter: $\varnothing 3.5$
 Material: brass with silver plating
 Contact resistance: $0.5m\ \Omega$

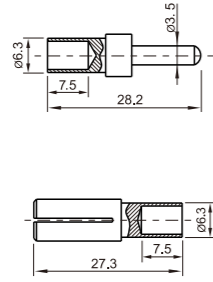
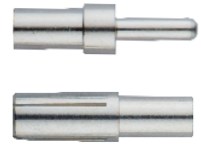

50A Male crimp contact For WS/WF/WY16

Wire size	Stripping length	Male crimp contact p/n	Crimping tool p/n
10.0mm ² AWG 7	10mm	YJ3.5-28.2	YQK-70

50A Female crimp contact For WS/WF/WY16

Wire size	Stripping length	Female crimp contact p/n	Crimping tool p/n
10.0mm ² AWG 7	10mm	YK3.5-27.3	YQK-70

100A Crimp contact

Contact diameter: $\varnothing 5.5$
 Material: brass with silver plating
 Contact resistance: $0.3m\ \Omega$

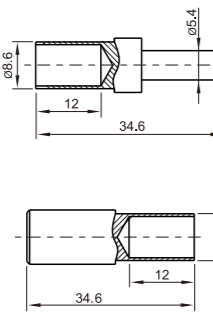
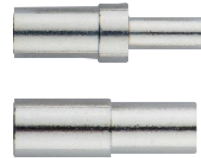

100A Male crimp contact For WS/WF/WY20

Wire size	Stripping length	Female crimp contact p/n	Crimping tool p/n
25mm ² AWG 3	10mm	YJ5.5-34.6	YQK-70

100A Female crimp contact For WS/WF/WY20

Wire size	Stripping length	Female crimp contact p/n	Crimping tool p/n
25mm ² AWG 3	10mm	GK5.5-30.8	YQK-70

Crimp tool

For crimping the male / female contacts



Part number	Crimping wire range
YQK-70	4-70mm ² AWG 11-2/0

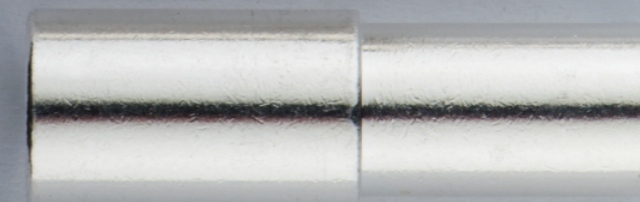
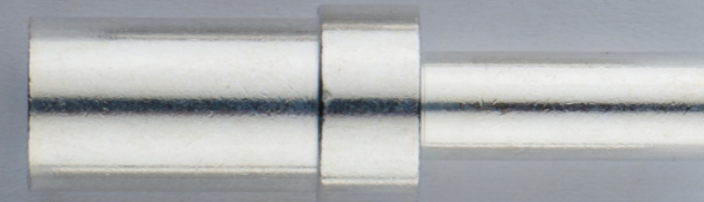
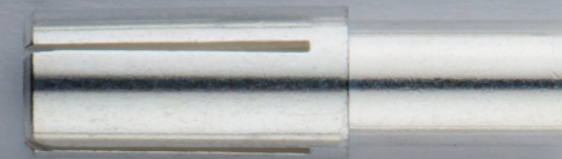
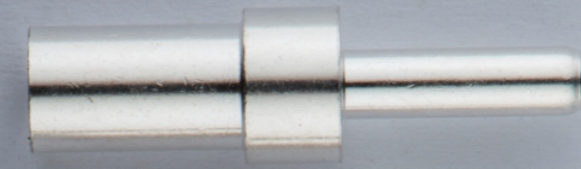

Screw contact spec

SF20, SA20, WS20, WF20, WY20	2	3	4
Male contact face view			
Rated current (A)	10	10	10
Contact diameter(mm)	∅2.5X2	∅2.5X3	∅2.5X4
Rated voltage (AC.V)	500	500	500
Test voltage(AC.V) 1 min	1500	1500	1500
Contact resistance (mΩ)	1	1	1
Wire size (mm ² /AWG)	≤1.5/15	≤1.5/15	≤1.5/15

SP21, SY21, WP20	2	3	4	5
Male contact face view				
Rated current (A)	10	10	10	10
Contact diameter(mm)	∅3×2	∅3×3	∅3×4	∅3×5
Rated voltage (AC.V)	500	500	500	500
Test voltage(AC.V) 1 min	1500	1500	1500	1500
Contact resistance (mΩ)	1	1	1	1
Wire size (mm ² /AWG)	≤1.5/15	≤1.5/15	≤1.5/15	≤1.5/15

SA24, WS24, WF24, WY24	2	3	4
Male contact face view			
Rated current (A)	10	10	10
Contact diameter(mm)	∅2.5X2	∅2.5X3	∅2.5X4
Rated voltage (AC.V)	500	500	500
Test voltage(AC.V) 1 min	1500	1500	1500
Contact resistance (mΩ)	1	1	1
Wire size (mm ² /AWG)	≤1.5/15	≤1.5/15	≤1.5/15

SA28, SP29, SY29 WS28, WF28, WY28	2	3	4	7	8	10
Male contact face view						
Rated current (A)	32	32	10	10	10	10
Contact diameter(mm)	∅3.5X2	∅3.5X3	∅2.5X4	∅2.5X7	∅2.5X8	∅2.5X10
Rated voltage (AC.V)	500	500	500	500	500	500
Test voltage(AC.V) 1 min	1500	1500	1500	1500	1500	1500
Contact resistance (mΩ)	0.5	0.5	1	1	1	1
Wire size (mm ² /AWG)	≤6/10	≤6/10	≤1.5/15	≤1.5/15	≤1.5/15	≤1.5/15

Screw contact spec

WS32, WF32, WY32	4	10B	11	12
Male contact face view				
Rated current (A)	32	10	10	10
Contact diameter(mm)	∅3.5X4	∅2.5X10	∅2.5X11	∅2.5X12
Rated voltage (AC.V)	500V	500V	500V	500V
Test voltage(AC.V) 1 min	1500V	1500V	1500V	1500V
Contact resistance (mΩ)	0.5	1	1	1
Insulation resistance (MΩ)	2000	2000	2000	2000
Wire size (mm ² /AWG)	≤6/10	≤1.5/15	≤1.5/15	≤1.5/15

WS40, WF40, WY40	5	9
Male contact face view		
Rated current (A)	32	10 32
Contact diameter(mm)	∅3.5X5	∅2.5X5 ∅3.5X4
Rated voltage (AC.V)	500	500
Test voltage(AC.V) 1 min	1500	1500
Contact resistance (mΩ)	0.5	1 0.5
Insulation resistance (MΩ)	2000	2000
Wire size (mm ² /AWG)	≤6/10	≤1.5/15 ≤6/10

WS48, WF48, WY48	7	20
Male contact face view		
Rated current (A)	32	10
Contact diameter(mm)	∅3.5X7	∅2.5X20
Rated voltage (AC V)	500	500
Test voltage(AC V) 1 min	1500	1500
Contact resistance (mΩ)	0.5	1
Insulation resistance (MΩ)	2000	2000
Wire size (mm ² /AWG)	≤6/10	≤1.5/15

Solder connect to crimp

SF16, SA16, SP17, SY17 WS16, WF16, WY16	2	3
Male contact face view		
Rated current (A)	10	10
Contact diameter(mm)	Ø1.5X2	Ø1.5X3
Rated voltage (AC.V)	500	500
Test voltage(AC.V) 1 min	1500	1500
Contact resistance(mΩ)	2.5	2.5
Insulation resistance (MΩ)	2000	2000

SF20, SA20, WS20, WF20, WY20	2	3	4	5	7
Male contact face view					
Rated current (A)	25	25	25	10	10
Contact diameter(mm)	Ø2.5X2	Ø2.5X3	Ø2.5X4	Ø1.5X5	Ø1.5X7
Rated voltage (AC.V)	500	500	500	500	500
Test voltage(AC.V) 1 min	1500	1500	1500	1500	1500
Contact resistance(mΩ)	1	1	1	2.5	2.5
Insulation resistance (MΩ)	2000	2000	2000	2000	2000

SA28, WS28, WF28, WY28	7
Male contact face view	
Rated current (A)	25
Contact diameter(mm)	Ø2.5X7
Rated voltage (AC.V)	500
Test voltage(AC.V) 1 min	1500
Contact resistance(mΩ)	1
Insulation resistance (MΩ)	2000

WS32, WF32, WY32	4	19
Male contact face view		
Rated current (A)	50	10
Contact diameter(mm)	Ø3.5X4	Ø1.5X19
Rated voltage (AC.V)	500	500
Test voltage(AC.V) 1 min	1500	1500
Contact resistance(mΩ)	0.5	2.5
Insulation resistance (MΩ)	2000	2000

WS40, WF40, WY40	31
Male contact face view	
Rated current (A)	10
Contact diameter(mm)	Ø1.5X31
Rated voltage (AC.V)	500
Test voltage(AC.V) 1 min	1500
Contact resistance(mΩ)	2.5
Insulation resistance (MΩ)	2000

Solder connect to crimp

WS48, WF48, WY48	42
Male contact face view	
Rated current (A)	10
Contact diameter(mm)	Ø1.5X42
Rated voltage (AC.V)	500
Test voltage(AC.V) 1 min	1500
Contact resistance(mΩ)	2.5
Insulation resistance (MΩ)	2000

WS55, WF55, WY55	61
Male contact face view	
Rated current (A)	10
Contact diameter(mm)	Ø1.5X61
Rated voltage (AC.V)	500
Test voltage(AC.V) 1 min	1500
Contact resistance(mΩ)	2.5
Insulation resistance (MΩ)	2000

Screw connect to crimp

SF20, SA20, WS20, WF20, WY20	2	3
Male contact face view		
Rated current (A)	10	10
Contact diameter(mm)	Ø2.5X2	Ø2.5X3
Rated voltage (AC.V)	500	500
Test voltage(AC.V) 1 min	1500	1500
Contact resistance(mΩ)	1	1
Insulation resistance (MΩ)	2000	2000

SA28, WS28, WF28, WY28	7
Male contact face view	
Rated current (A)	10
Contact diameter(mm)	Ø2.5X7
Rated voltage (AC.V)	500
Test voltage(AC.V) 1 min	1500
Contact resistance(mΩ)	1
Insulation resistance (MΩ)	2000

WS32, WF32, WY32	4
Male contact face view	
Rated current (A)	32
Contact diameter(mm)	Ø3.5X4
Rated voltage (AC.V)	500
Test voltage(AC.V) 1 min	1500
Contact resistance(mΩ)	0.5
Insulation resistance (MΩ)	2000