

28.110

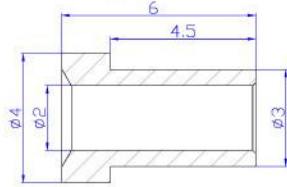

Material

Body: Brass
Surface: Gold plated



28.320



Material

Body: Brass
Spring: Beryllium copper
Surface: Gold plated

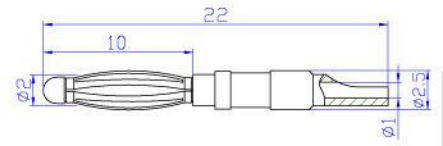

28.210



Material

Body: Brass
Surface: Gold plated

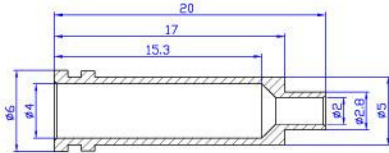

28.33*



Item No.	T	L
28.330	M2.0	6.5
28.331	M2.5	6.5
28.332	M3.0	6.5

Material

Body: Brass
Spring: Beryllium copper
Surface: Gold plated

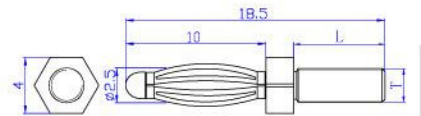

28.220



Material

Body: Brass
Surface: Nickel plated

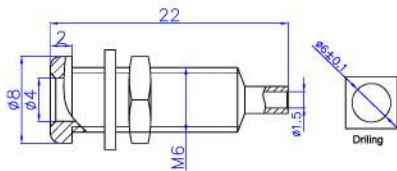

28.340



Material

Body: Brass
Spring: Beryllium copper
Surface: Gold plated

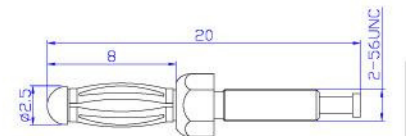

28.230



Material

Body: Brass
Surface: Nickel plated

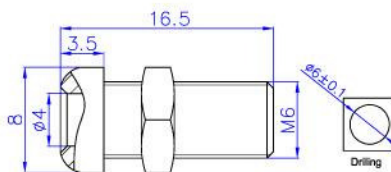

28.350



Material

Body: Brass
Spring: Beryllium copper
Surface: Gold plated

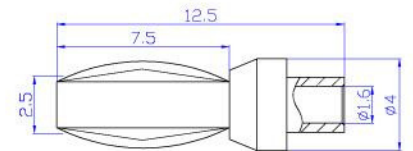

28.310



Material

Body: Brass
Surface: Gold plated

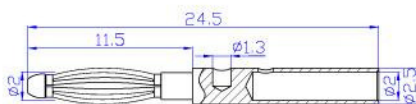

28.36*



Item No.	T	L
28.360	M2.0	6.5
28.361	M2.0	10.0
28.362	M2.5	6.5

Material

Body: Brass
Spring: Beryllium copper
Surface: Gold plated

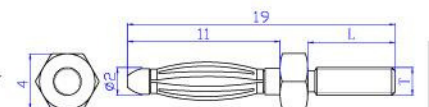

28.370



Material

Body: Brass
Spring: Beryllium copper
Surface: Nickel plated

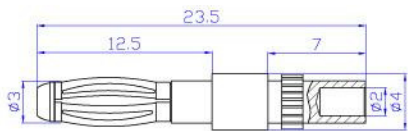

28.440



Material

Body: Brass
Spring: Beryllium copper
Surface: Nickel plated

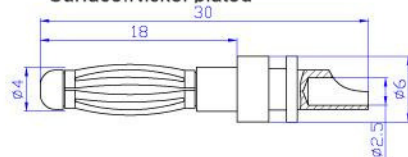

28.41*



Material

Body: Brass
Spring: Beryllium copper
Surface: Nickel plated

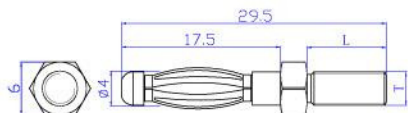

28.450



Material

Body: Brass
Spring: Beryllium copper
Surface: Nickel plated

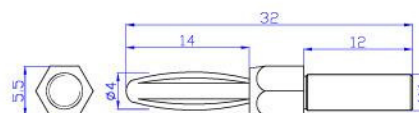

28.46*



Material

Body: Brass
Spring: Beryllium copper
Surface: Nickel plated

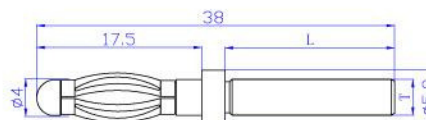

Item No.	T	L
28.410	M3.0	6.0
28.411	M3.0	10.0
28.412	M4.0	4.5
28.413	M4.0	6.0
28.414	M4.0	9.0
28.415	M4.0	18.0

Item No.	T	L
28.460	M3.0	3.0
28.461	M3.0	6.5
28.462	M4.0	6.0
28.463	M4.0	9.0

28.420



Material

Body: Brass
Spring: Beryllium copper
Surface: Gold plated

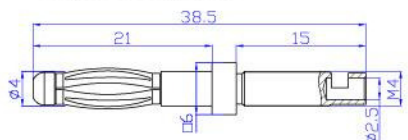

28.430



Material

Body: Brass
Spring: Beryllium copper
Surface: Gold plated

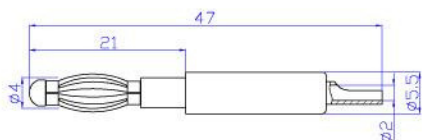

28.510



Material

Body: Brass
Spring: Beryllium copper
Surface: Nickel plated

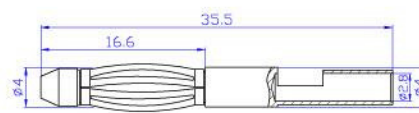

28.520

Material

Body: Brass
Spring: Beryllium copper
Surface: Nickel plated

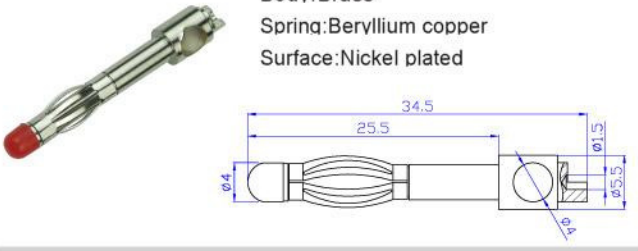

28.620

Material

Body: Brass
Spring: Beryllium copper
Surface: Silver plated

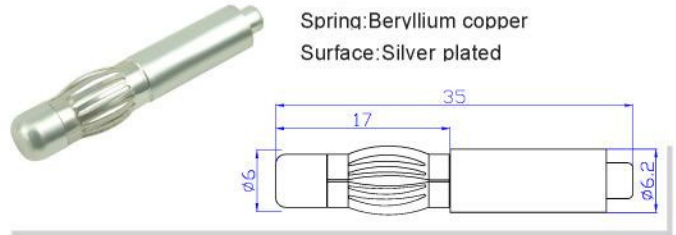

28.610

Material

Body: Brass
Spring: Beryllium copper
Surface: Gold plated



28.910

Material

Body: Copper
Surface: Nickel plated

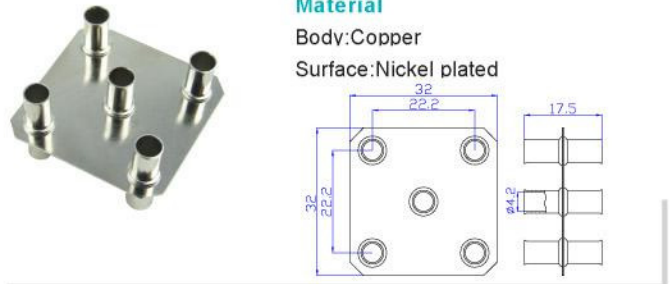

28.710

Material

Body: Brass
Spring: Beryllium copper
Surface: Nickel plated

