

26.221.*

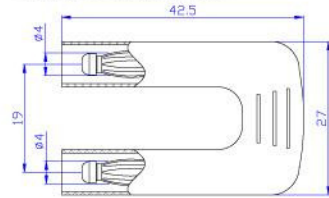

Material
 Insulator:ABS
 Body:Brass
 Spring:Beryllium copper
 Surface:Nickel plated
Rated voltage/current
 CAT II 1000V/Max.32A



2

26.460.*

Material
 Body:Brass
 Spring:Beryllium copper
 Surface:Nickel plated
Rated voltage/current
 30Vac-60Vdc/Max.32A

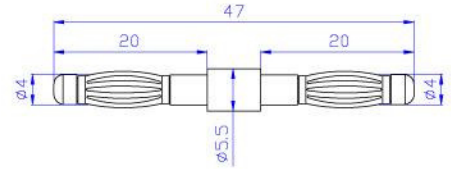

26.222.*



Material
 Insulator:PA
 Body:Brass
 Spring:Beryllium copper
 Surface:Nickel plated
Rated voltage/current
 CAT II 1000V/Max.32A

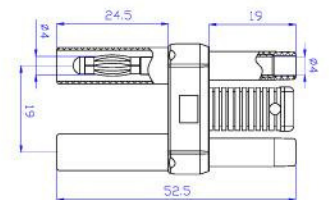

2

26.410.*



Material
 Insulator:PVC
 Body:Brass
 Surface:Nickel plated
Rated voltage/current
 30Vac-60Vdc/Max.19A

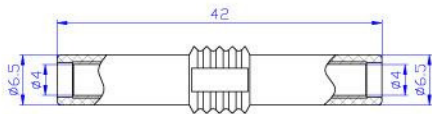

26.420.*



Material
 Insulator:PVC
 Body:Brass
 Surface:Nickel plated
Rated voltage/current
 30Vac-60Vdc/Max.24A

