

## CONTROL STATIONS

### Double Insulated, For Control Circuits Complete System

#### “Start” or “Stop” Function(grey lid with dark grey base)



SAL-B101H29

Description	Scheme	Marking on legend	Marking on pushbutton	Model
1 green flush pushbutton spring-return	1 N/O	Start	-	SAL-B101H29
		-		SAL-B102
		-	Start	SAL-B103

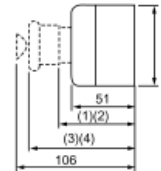

SAL-B132H29

1 red flush pushbutton spring-return	1 N/C	Stop	-	SAL-B111H29
		-	Stop	SAL-B114
		-	○	SAL-B112

1 red mushroom head pushbutton, $\phi$ 40mm, spring-return	1 N/C	Emergency Stop	-	SAL-B164H29
		-	○	SAL-B116

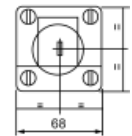

SAL-B142H29

1 red extended pushbutton	1 N/C	-	Stop	SAL-B116
		Stop	-	SAL-B132H29

1 selector switch 2-position latching standard handle	1 N/O	Start	-	SAL-B134
		○	-	SAL-B134
		-	-	SAL-B142H29

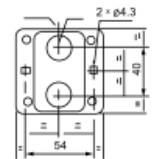

SAL-B174

#### “Emergency stop” Function with Frigger Action Mechanism (yellow lid with dark grey base)

Description	Scheme	Function marking	Model	Appearance Dimension
1 red mushroom head pushbutton, $\phi$ 40mm latching release device	1 N/C	● Red	SAL-B174	
		● Black	SAL-J178	



SAL-B188

1 red mushroom head pushbutton, $\phi$ 40mm latching Key release(key return n ° 455)	1 N/C	● Red	SAL-B188
		● Black	SAL-J188

## CONTROL STATIONS

### Double insulated, For Control Circuits Complete System

#### “Start-Stop” Function(light grey lid with dark base)



SAL-B213



SAL-B222



SAL-B334



SAL-B361H29



SAL-B339

Description Color	Scheme	Marking on legend	Marking on pushbutton	Model	Appearance Dimension
2 spring-return pushbutton 1 green flush 1 red flush	1 N/O	Start	-	SAL-B211H29	
	+	Stop	-		
1 green flush 1 red flush	1 N/C	-	1 0	SAL-B213	
	+	-	Start Stop	SAL-B215	
2 spring-return pushbutton 1 white flush (white arrow) 1 black flush (black arrow)	1 N/O	-		SAL-B222	
	+	-			
1 white flush (white arrow) 1 black flush (black arrow)	1 N/O	-		SAL-B223	
	+	-			

#### “Start” or “Stop” Function with Pilot Light(grey lid with dark grey base)

Description	Scheme	Marking on legend	Marking on pushbutton	Model	Appearance Dimension
1 red pilot light supply ≤ 130V not include bulb		Stop	-	SAL-B361H29	
		Start	-		
2 spring-return pushbutton 1 green flush 1 red flush	1 N/O	-	1 0	SAL-B363	
	+	-	Stop Start	SAL-B366	
3 spring-return pushbutton 1 green flush 1 red flush 1 green flush	1 N/O	Forward		SAL-B311H29	
	+	Stop		SAL-B339	
1 green flush 1 red flush 1 green flush	1 N/C	Reverse		SAL-B321H29	
	+	Up	-		
3 spring-return pushbutton 1 white flush (black arrow) 1 red flush 1 black flush (white arrow)	1 N/O	Up	-	SAL-B324	
	+	Stop			
1 red flush 1 black flush (white arrow)	1 N/C	Down	-	SAL-B334	
	+	Down			