

D4010H12B/S

1. MODEL NUMBER	D4010H12B(X1)	D4010H12S(X1)
2. CATEGORY	BRUSHLESS DC FAN	BRUSHLESS DC FAN
3. FRAME SIZE	40 x 40 x 10 mm (1.6 x 1.6 x 0.4 inch)	40 x 40 x 10 mm (1.6 x 1.6 x 0.4 inch)
4. RATED VOLTAGE	12 VDC	12 VDC
5. OPERATING VOLTAGE RANGE	9 V ~ 15V	9 V ~ 15V
6. START-UP VOLTAGE	9 V / Min.	9 V / Min.
7. RATED MOTOR SPEED	7000 RPM ±10%	7000 RPM ±10%
8. AIR FLOW	7.9 CFM (0.22 m ³ /Min.)	7.9 CFM (0.22 m ³ /Min.)
9. STATIC PRESSURE	3.77 mm/H ₂ O (0.15 inch/H ₂ O)	3.77 mm/H ₂ O (0.15 inch/H ₂ O)
10. RATED CURRENT	0.07 Amp ±10%	0.07 Amp ±10%
11. RATED INPUT POWER	0.84 Watts ±10%	0.84 Watts ±10%
12. NOISE LEVEL	30.30 dB(A)	30.30 dB(A)
13. DIRECTION OF ROTATION	Clockwise viewed from front label	Clockwise viewed from front label
14. OPERATING TEMPERATURE	-10°C ~ + 70°C / 66% (RH)	-10°C ~ + 70°C / 66% (RH)
15. STORAGE TEMPERATURE	-40°C ~ + 75°C / 66% (RH)	-40°C ~ + 75°C / 66% (RH)
16. BEARING SYSTEM	BALL BEARING	SLEEVE BEARING
17. LIFE EXPECTANCY	70,000 Hrs	30,000 Hrs
18. SAFETY APPROVAL	UL, CUL, TUV, CE	UL, CUL, TUV, CE
19. WEIGHT	16 gm	16 gm

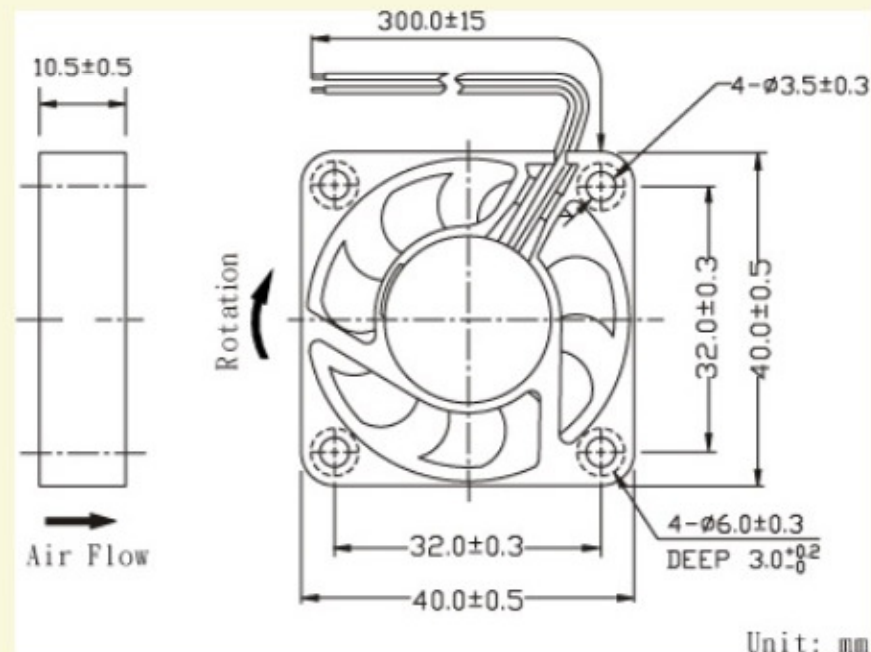

Unit: mm