

**Material :**

- Ⓐ Housing : PA66(UL94V-0)
- Ⓑ Pin Header : Brass , Tin Plated

**Electrical :**

- |   |      |      |
|---|------|------|
|   | UL   | IEC  |
| 1. Rated Voltage :                        | 300V | 320V |
| 2. Rated Current :                        | 15A  | 20A  |
| 3. Withstanding Voltage : AC1600V/1Min.   |      |      |
| 4. Operating Temperature : -40 °C~+105 °C |      |      |
| 5. RoHS Compliance                        |      |      |
| 6. Safety Approval :                      |      |      |
| 7. Undimensioned Tolerances:              |      |      |

Pitch Range In mm			Nominal Dimension Range In mm					—	∩	∇
≤6	6 ~ 10	10 ~ 24	≤30	30 ~ 60	60 ~ 100	100 ~ 150	>150	0.05/10		
±0.10	±0.15	±0.25	±0.20	±0.30	±0.50	±0.70	±1.00	±0.1°		

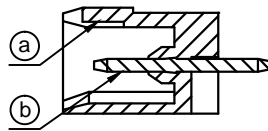
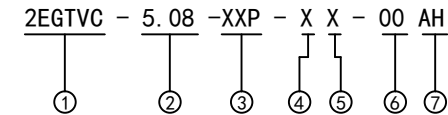
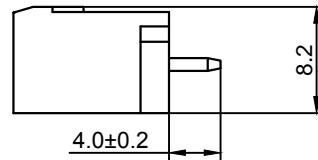
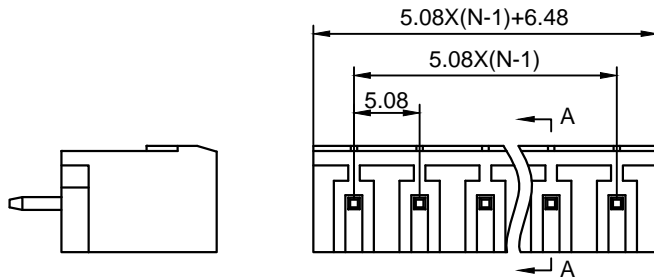

A-A

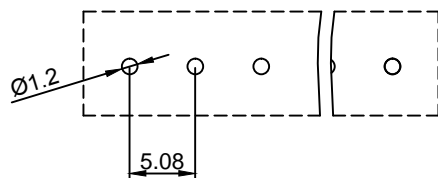

- ① Series No.
- ② Pitch
- ③ Poles  
02 02Contacts  
03 03Contacts  
...  
24 24Contacts
- ④ 1 Single Pitch  
2 Double Pitch
- ⑤ Color: 1 Grey  
2 Blue  
3 Black  
4 Green(Standard For AH)  
5 Orange  
6 Red  
7 Transparent  
8 Yellow  
9 White
- ⑥ Customer Request: 00--Standard
- ⑦ AH--Standard(PA66)

DETACHED LISTS	<b>Golten</b> 宁波冠泰电子有限公司 NINGBO GOLTEN ELECTRONICS CO., LTD.	
	APPD: MA_4/11/16'	PART NO. 2EGTVC-5.08-XXP-XX-00AH
	CHKD: Yu_4/10/16'	
	DRFT: Chen_4/9/16'	
	THIRD ANGLE PROJECTION	
	MM (INCH)	DO NOT SCALE DRAWING
	REV	1
	SHEET	1/1
	SCALE	1/1