

**LW26 Series rotary switches**

**Introduction**

- LW26 series rotary switches represent the most advanced rotary switches. We currently have six models, current rating up to 160A, suitable for wide variety of applications;
- LW26 series rotary switches are suitable for: on-off of an electrical circuit, change-over of electrical circuits, motor switch, instrument switch, and main switch;
- LW26 series rotary switches comply with: GB 14048.3, GB 14048.5, and IEC 60947-5-1;
- LW26 series rotary switches have six current ratings: 20A, 25A, 32A, 63A, 125A, and 160A. LW26-20 and LW26-25 has the fingerproof terminals, which offered an extra advantage;
- LW26 series rotary switches have wide variety of applications, they are ideal substitution for LW2, LW5, LW6, LW8, LW12, LW15, HZ5, HZ10, HZ12, and other rotary switches and cam switches;
- LW26 series rotary switch has two derivatives: LW26GS Pak-lock type switch (63A and below) and LW26S Key-lock type switch (32A and below), which could be installed in instruments to prevent the equipments from mis-operations.

**Working conditions**

- Ambient temperature Do Not exceed 40°C, and the average temperature, measured over a period of 24 hours, Do Not exceed 35;
- Ambient temperature Do Not less than -5°C;
- Should Not be installed above 2000m above sea level;
- A clean environment was required.



LW26-20



LW26-32



LW26-63



LW26-160

**1**



LW26-25



LW26-32



LW26-63



LW26-125

**LW26 Series rotary switches**

**Designation**

Use as control switches

$\frac{LW}{1} \frac{26}{2} \frac{\square}{3} \frac{\square}{4} \frac{\square}{5} \frac{\square}{6} / \frac{\square}{7}$

- 1: Rotary switch (Cam switch);
- 2: Product code;
- 3: Rated thermal current;
- 4: Code of the degree of rotation;
- 5: Character code;
- 6: Code for contact of the switch;
- 7: Number of layers.

Re: Character code represent the rotating type, for instance, we have limited movement, spring return and limited movement with spring return.

**Use as control switches**

$\frac{LW}{1} \frac{26}{2} - \frac{\square}{3} / \frac{\square}{4} \frac{\square}{5} \cdot \frac{\square}{6}$

- 1: Rotary switch (Cam switch);
- 2: Product code;
- 3: Rated thermal current;
- 4: Motor Rating (3 phase AC);
- 5: Usage Code: 1 Q for start and run;  
 2 N for reversing;  
 3 S for 2 speed;  
 4 SN for 2 speed and reversing;
- 6: Number of layers.

Re: switches in this category normally rotate at 60 . And the SN normally rotate at 45.

**Use as control switches**

$\frac{LW}{1} \frac{26}{2} - \frac{\square}{3} / \frac{\square}{4}$

- 1: Rotary switch (Cam switch);
- 2: Product code;
- 3: Rated thermal current;
- 4: Number poles: 2 poles, 3poles, and 4poles.

Re: switches in this category normally rotate at 60.

**LW26 Series rotary switches**

**Classification**

- Classified by utilization:
  - (1)Change-over switch;
  - (2)Motor switch;
  - (3)Control switch;
- Classified by operation:
  - (1)Limited movement;
  - (2)Spring return;
  - (3)Limited movement with spring return;
- Classified by contact system:
  - (1)Switches with limited movement could have 12 layers in maximum (for 32A and below), and for 63A and above could have 8 layers in maximum;
  - (2)Switches with spring return could have 3 layers in maximum;
  - (3)Motor switches could have 6 layers in maximum.
- Diagram for the operation and position of handle.

Operation angle	Character code	Position of handle																	
		30 Rotation																	
Spring return	A									0°	←	30°							
	B								30°	→	0°	←	30°						
	C									0°			30°						
	D								30°	0°			30°						
	E								30°	0°			30°	60°					
	F							60°	30°	0°			30°	60°					
	G							60°	30°	0°			30°	60°					
	H							60°	30°	0°			30°	60°	90°				
	I				90°			60°	30°	0°			30°	60°	90°				
	J			120°	90°			60°	30°	0°			30°	60°	90°	120°			
	K			120°	90°			60°	30°	0°			30°	60°	90°	120°	150°		
	L			150°	120°	90°			60°	30°	0°			30°	60°	90°	120°	150°	
	M			150°	120°	90°			60°	30°	0°			30°	60°	90°	120°	150°	180°
	N																		
Limited movement with spring return	Z									30°	→	0°		60°					

Operation angle	Character code	Position of handle																				
		45 Rotation				60 Rotation				90 Rotation												
Spring return	A																					
	B																					
	C														0°		60°		0°	90°		
	D														60°	0°		60°	90°	0°	90°	
	E														90°	30°	30°	90°	90°	0°	90°	180°
	F				90°										90°	30°	30°	90°	150°			
	G				90°										150°	90°	30°	30°	90°	150°		
	H			135°	90°																	
	I			135°	90°																	
	J																					
	K																					
	L																					
	M																					
	N																					
Limited movement with spring return	Z																					

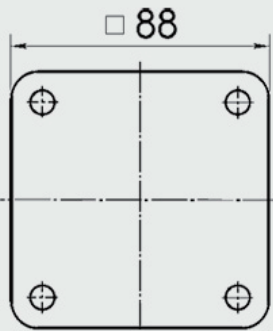
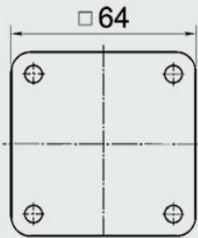
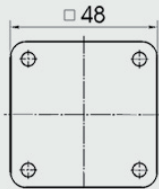

1

Escutcheon plate



**LW26 Series rotary switches**

Escutcheon plate

Type of handle	Color	Escutcheon plate			Type of handle	Color	Escutcheon plate		
		M1	M2	M3			M1	M2	M3
R 	Black	●	●	●	I 	Black	●	●	
	Red	●	●	●		Red	●	●	
	White	●	●	●		White	●	●	
	Gray	●	●	●		Gray	●	●	
F 	Black	●	●		B 	Black	●	●	
	Red	●	●			Red	●	●	
	White	●	●			White	●	●	
	Gray	●	●			Gray	●	●	
S 	Black	●	●		L 	Black		●	
	Red	●	●			Red		●	
	White	●	●			White		●	
	Gray	●	●			Gray		●	
P 	Black		●	●	K 	Black		●	●
	Red		●	●		Red		●	●
	White		●	●		White		●	●
	Gray		●	●		Gray		●	●

Re: ● Standard ● Optional.

Product	Escutcheon plate			Type of handle								Rotating angle				Maximum Number	
	M1	M2	M3	R	F	I	B	S	L	P	K	30	45	60	90	12	8
LW26-20	●	●		●	●	●	●	●				●	●	●	●	●	
LW26-25	●	●		●	●	●	●	●				●	●	●	●	●	
LW26-32		●		●	●	●	●	●		●	●	●	●	●	●	●	
LW26-63		●	●	●	●	●	●	●		●	●	●	●	●	●		●
LW26-125			●	●								●	●	●	●		●
LW26-160			●	●								●	●	●	●		●

**LW26 Series rotary switches**

**Technical parameters**

Description	LW26-20	LW26-25	LW26-32	LW26-63	LW26-125	LW26-160
Rated insulation voltage $U_i$	V 690	690	690	690	690	690
Rated thermal current $I_{th}$	A 20	25	32	63	125	160
Rated working voltage $U_e$	V 120 240 440	120 240 440	120 240 440	240 440	240 440	240 440
Rated working current $I_e$						
AC-21A	A 20	20	25	25	32	32
AC-22A					63	63
AC-23A	A 15	15	22	22	30	30
AC-2	A 15	15	22	22	30	30
AC-3	A 11	11	15	15	22	22
AC-4	A 3.5	3.5	6.5	6.5	11	11
AC-15	A 5	4	8	5	14	6
DC-13	A 1		9	1.5	25	11
Power P						
AC-23A	kW	3.7/235	7.5/3.7	5.5/3	11/5.5	7.5/4
AC-2	kW	4	7.5	5.5	11	7.5
AC-3	kW	3/2.2	5.5/3	4/3	7.5/3.7	5.5/4
AC-4	kW	0.55/0.75	1.5/1.5	1.5/1.1	3/2.2	2.7/1.5

Re: Neutral;

Re: The power under AC-23A AC-3 AC-4 are in three phase three pole, and the divider represents the power under single phase two pole.

**Mechanical life**

- Mechanical life without load:  $60 \times 10^4$  times, operation frequency is 120 times/h;
- Mechanical life with load:  $20 \times 10^4$  times under AC-15,  $6 \times 10^4$  times under DC-13, operation frequency is 300 times/h.

**Order procedures**

In order to avoid any mistake during the order, customers should follow the right procedure'

The following information should be supplied:

- Contact diagram, we have published «Contact diagram for LW5D series rotary switches», the diagram applied for LW5D could applied to LW26 series as well. And we have selected some typical diagrams in this catalog;
- Type of escutcheon plate;
- Type of handle;
- Character code and code of degree of rotation;
- Rated current;
- Quantity.

We reserve the right to update the data in this catalog, and we are not responsible for any change of data in this catalog.

**LW26 Series rotary switches**

**Dimensions and installation**

Square escutcheon plate and square escutcheon plate with rectangle plate added

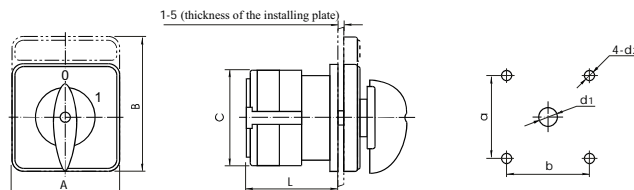

Description	Escutcheon plate	Dimensions(mm)				Installation(mm)			
		A	B	C	L	a	b	d1	d2
LW26-20	M1 square	48	48	43	22+9.6n	36	36	ø8.5	ø4.5
LW26-20	M1 square with rectangle plate added	48	60	43	22+9.6n	36	36	ø8.5	ø4.5
LW26-20	M2 square	64	64	43	25+9.6n	48	48	ø10	ø4.5
LW26-20	M2 square with rectangle plate added	64	80	43	25+9.6n	48	48	ø10	ø4.5
LW26-25	M1 square	48	48	45.2	23+12.8n	36	36	ø8.5	ø4.5
LW26-25	M1 square with rectangle plate added	48	60	45.2	23+12.8n	36	36	ø8.5	ø4.5
LW26-25	M2 square	64	64	45.2	26.5+12.8n	48	48	ø10	ø4.5
LW26-25	M2 square with rectangle plate added	64	80	45.2	26.5+12.8n	48	48	ø10	ø4.5
LW26-32	M2 square	64	64	58	29.2+12.8n	48	48	ø10	ø4.5
LW26-32	M2 square with rectangle plate added	64	80	58	29.2+12.8n	48	48	ø10	ø4.5
LW26-63	M2 square	64	64	66	29.2+21.5n	48	48	ø10	ø4.5
LW26-63	M2 square with rectangle plate added	64	80	66	29.2+21.5n	48	48	ø10	ø4.5
LW26-63	M3 square	88	88	66	29.2+21.5n	68	68	ø10	ø4.5
LW26-63	M3 square with rectangle plate added	88	107	66	29.2+21.5n	68	68	ø10	ø4.5
LW26-125	M3 square	88	88	84	35+26.5n	68	68	ø13	ø6
LW26-125	M3 square with rectangle plate added	88	107	84	35+26.5n	68	68	ø13	ø6
LW26-160	M3 square	88	88	88	35+32.5n	68	68	ø13	ø6
LW26-160	M3 square with rectangle plate added	88	107	88	35+32.5n	68	68	ø13	ø6

Re: n for number of layers.

**Single hole installation**

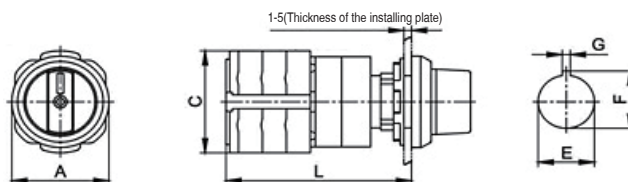

**Double hole installation**

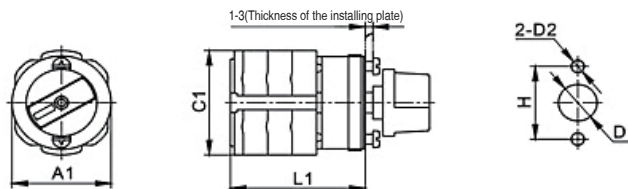

Description	Dimensions (mm)						Installation (mm)					
	A	C	L	A1	C1	L1	E	F	G	H	D1	D2
LW26-10	ø29	28	35+8n				ø16.2	18	1.9			
LW26X-10	ø29	28	39+12n				ø16.2	18	1.9			
LW26-20	ø39	43	35+9.6n				ø30.5	33	4.8			
LW26-20	ø39	43	42+9.6n	ø39	43	24+9.6n	ø22.3	24.1	3.2	30	ø15	ø5
LW26X-20	ø39	46	42+14n	ø39	46	25+14n	ø22.3	24.1	3.2	30	ø15	ø5
LW26-25	ø39	45.5	42+12.8n	ø39	45.2	25+12.8n	ø22.3	24.1	3.2	30	ø15	ø5
LW26-32F	ø39	48	42+14n	ø39	48	25+14n	ø22.3	24.1	3.2	30	ø15	ø5

**LW26 Series rotary switches**

**Q Type**

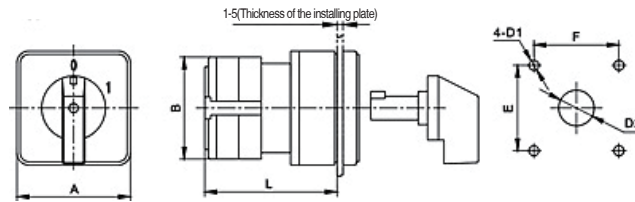

Description	Escutcheon plate	Dimensions (mm)			Installation (mm)			
		A	B	L	E	F	D1	D2
LW26-20	M1 Square	48	43	38+9.6n	36	36	ø4.2	ø15
LW26-25	M1 Square	48	45.2	39+12.8n	36	36	ø4.2	ø15
LW26-32F	M1 Square	48	48	39+14n	36	36	ø4.2	ø15

Re: n for number of layers.

**Protective box**

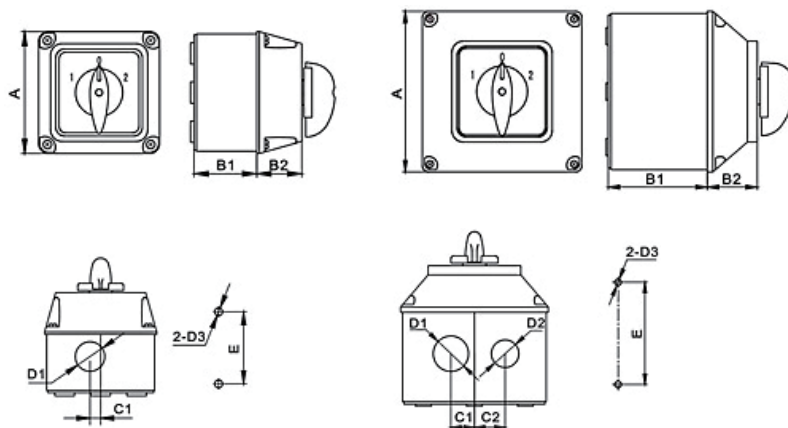

Description	Dimensions (mm)						Installation (mm)		
	A	B1	B2	C1	C2	D1	D2	D3	E
LW26-20	□68.5	35.5	25.5	6.5		ø18		ø5	44
LW26-20	□68.5	45	25.5	6.5		ø18		ø5	44
LW26-20	□68.5	35.5	32.5	6.5		ø18		ø5	44
LW26-20	□68.5	45	32.5	6.5		ø18		ø5	44
LW26-25	□68.5	35.5	25.5	6.5		ø18		ø5	44
LW26-25	□68.5	45	25.5	6.5		ø18		ø5	44
LW26-25	□68.5	35.5	32.5	6.5		ø18		ø5	44
LW26-25	□68.5	45	32.5	6.5		ø18		ø5	44
LW26-32F	□68.5	35.5	25.5	6.5		ø18		ø5	44
LW26-32F	□68.5	45	25.5	6.5		ø18		ø5	44
LW26-32F	□68.5	35.5	32.5	6.5		ø18		ø5	44
LW26-32F	□68.5	45	32.5	6.5		ø18	ø21	ø5	44
LW26-32	□113	70.5	35.5	18	23.5	ø27	ø21	ø5	78
LW26-63	□113	70.5	35.5	18	23.5	ø27	ø21	ø5	78





**LW26 Series rotary switches**

**Special type and optional extras**

1

Applicable type	Description		
LW26X-10 LW26X-20	Product with angled terminals		
 LW26-10 □ •A10I	 LW26X-10 □ •A10I	 LW26X-20 □ •A31I	
LW26-32F	32A Fringer prove		
 LW26-32F □ •A11I	 LW26-32F □ •C55I	 LW26-32F □ •C51S1	
LW26-10 LW26X-10 LW26-20 LW26X-20 LW26-25 LW26-32F	Single hole installation		
 LW26X-10 □ • C10I	 LW26-25 □ • C55I	 LW26-20 □ • C11B	 LW26-32F □ • C11I
LW26-20 LW26X-20 LW26-25 LW26-32F	Double hole installation  LW26-25 □ • G88B	Paralle installation  LW26-20 □ • D11R	
LW26-20	Spring return with limited movement  LW26-20 □ • A11R	Spring return with multipal position  LW26-20 □ • A11R	Putout type  LW26-20 □ • A32P1



**LW26 Series rotary switches**

**Special type and optional extras**

Applicable type	Description		
LW26-20 LW26X-20 LW26-25	Single lock	B Type handle	
			
	LW26-25 □ • A11DS	LW26-25 □ • C55B	LW26-20 □ • C55B
LW26-20 LW26X-20 LW26-25 LW26-32F	Indicating light	Indicating light with keylock	
			
	LW26-20 □ • A66I	LW26-25 □ • A66S1	
	Rectangle plate		
			
	LW26-20 □ • A21R	LW26-20 □ • A41I	LW26-32 □ • A22R
			
	LW26-63 □ • A42I		
LW26-20 LW26-25 LW26-32 LW26-63	Protective box		
			
	LW26-20 □ • E31I	LW26-20 □ • E31GS	LW26-20 □ • E11S1
			
	LW26-20 □ • E11DS		LW26-32 □ • E12R
LW26-20 LW26-25 LW26-32 LW26-63 LW26-125 LW26-160	Rear installation	Special type for DC circuits	Protective cover
			
	LW26-25 □ • B11R	LW26-25 □ • A11R2	LW26-20 □ • F11R

**LW26 Series rotary switches**

Special type and optional extras

1

Applicable type	Description
LW26-20 LW26-25 LW26-32F	<p>Q Type</p>  <p>                         LW26-20 <input type="checkbox"/> • A1114                              LW26-25 <input type="checkbox"/> • A3114                              LW26-32F <input type="checkbox"/> • A1114                     </p>



LW26GS-25/04



LW26GS-32/04



LW26GS-20/04-1



LW26GS-63/04



LW26GS-32/04-1

**LW26GS Series pak-lock type switches**

**Introduction**

LW26GS series Pad-lock type switches are derivatives of LW26 series rotary switches. Installed in equipment where it requires a pad-lock to lock the switch in certain position. For instance, to fix the switch in ON position, to avoid the unauthorized personnel from operating the switch. LW26GS series Pad-lock type switch complies with the GB 14048.3 and IEC 60947.3.

**Classification**

■ LW26GS series Pad-lock type switches have four current ratings: 20A, 25A, 32A and 63A. LW26GS-20 has two escutcheon plate types, small escutcheon plate and large escutcheon plate. Others have only large escutcheon plate. Please check out the Dimensions and installation for details;

The figure 1 represents small escutcheon plate, and 2 represents large escutcheon plate. Small escutcheon plate allows two pad-locks and large escutcheon plate allows three pad-locks;

■ LW26GS series Pad-lock switches have Quick-stop and Normal if classified by operation; Normal(LW26GS/03) has Black escutcheon plate and Black handle; Quick-stop(LW26GS /04) has Red escutcheon plate and Red handle.

**Technical parameters**

Description	LW26GS-20	LWGS26-25	LWGS26-32	LWGS26-63	LWGS26-125	LWGS26-160
Rated insulation voltage Ui	V 440	440	440	440	440	440
Rated working voltage Ue	V 20	25	32	63	125	160
Rated thermal current Ith	A 20	25	32	63	100	150

**Rated working current Ie**

AC-21A	A 20	25	32	63	100	150
AC-22A	A 20	25	32	63	100	150
AC-23A	A 15	22	30	57	90	135

**Power P**

AC-23A	kW 7.5	11	15	30	45	75
--------	--------	----	----	----	----	----

**Operation**

Non-load	8500	8500	8500	8500	8500	8500
Load	1500	1500	1500	1500	1500	1500
Total	10 000	10 000	10 000	10 000	10 000	10 000

**Dimension and installation**

■ LW26GS-□/□-□

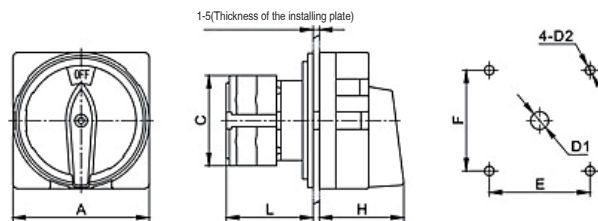

Description	Escutcheon plate	Dimensions (mm)				Installation (mm)			
		A	C	L	H	E	F	D1	D2
LW26GS-20	M1	□48	43	42	33	36	36	ø8.5	ø4.5
LW26GS-20	M2	□64	43	43	42	48	48	ø8.5	ø4.5
LW26GS-25	M1	□48	45.5	50	33	36	36	ø8.5	ø4.5
LW26GS-25	M2	□64	45.5	51	42	48	48	ø8.5	ø4.5
LW26GS-32	M2	□64	58	55	42	48	48	ø10	ø4.5
LW26GS-32	M3	□88	58	55	52	68	68	ø13	ø6
LW26GS-63	M2	□64	66	72.5	42	48	48	ø10	ø4.5
LW26GS-63	M3	□88	66	72.5	52	68	68	ø13	ø6
LW26GS-125	M3	□88	84	88	52	68	68	ø13	ø6
LW26GS-160	M3	□88	88	100	52	68	68	ø13	ø6



LW26S-25



LW26S-32

**LW26S Series key-lock type switches**

**Introduction**

- LW26S Key-lock type switches are derivatives of LW26 rotary switches. Installed in equipments, which requires a key to lock the switch. It prevents the mis-operation of the equipments from the unthorised personnel;
- LW26S Key-lock type switches comply with the GB 14048.3 and IEC 60947-3.

**Classification**

- LW26S Key-lock type switch has three current ratings: 20A, 25A and 32A. And in terms of the lock design, we have A type and B type for customers to chose.

**Technical parameter**

Description		LW26S-10	LW26S-20	LW26S-25	LW26S-32	LW26S-63
Rated working voltage Ue	V	440	440	440	440	440
Rated thermal current Ith	A	10	20	25	32	63
<b>Rated working current Ie</b>						
AC-21A	A	10	20	25	32	63
AC-22A	A	10	20	25	32	63
AC-23A	A	7	15	22	30	57
<b>Power P</b>						
AC-23A	kW	3	7.5	11	15	30

**Dimension and installation**

- LW26S S1

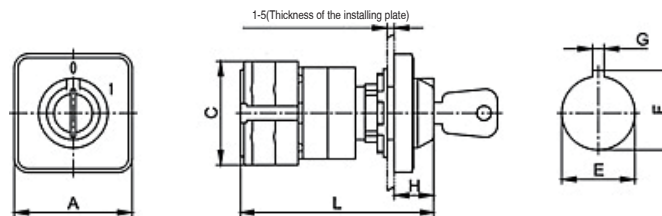

Deiscription	Dimensions (mm)				Installation (mm)		
	A	C	H	L	E	F	G
LW26S-10	□30	28	8.5	71.5	ø16.2	18	1.9
LW26S-20	□48	43	15.6	76.5	ø22.3	24.1	3.2
LW26S-20	□64	43	15.6	76.5	ø22.3	24.1	3.2
LW26S-25	□48	45.2	15.6	83	ø22.3	24.1	3.2
LW26S-25	□64	45.2	15.6	83	ø22.3	24.1	3.2
LW26S-32F	□48	48	15.6	86.5	ø22.3	24.1	3.2
LW26S-32F	□64	48	15.6	86.5	ø22.3	24.1	3.2

**Dimension and installation**

■ LW26S S2

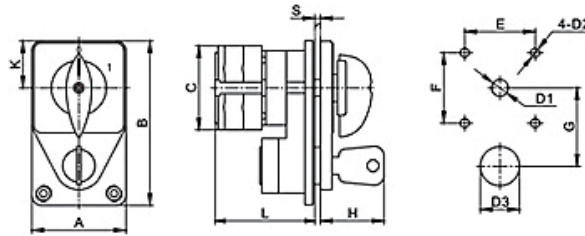

Description	Dimensions (mm)							Installation (mm)					
	A	B	K	C	L	H	S	E	F	G	D1	D2	D3
LW26S-20	48	84	24	43	51.5	32.5	1-4	36	36	40	ø8.5	ø4.5	ø20
LW26S-25	48	84	24	45.5	58	32.5	1-4	36	36	40	ø8.5	ø4.5	ø20
LW26S-32	64	112	32	58	72	34	1-6	48	48	48	ø10	ø4.5	ø34
LW26S-32F	48	84	24	48	61.5	32.5	1-4	36	36	40	ø8.5	ø4.5	ø20
LW26S-63	64	112	32	66	79	34	1-6	48	48	48	ø10	ø4.5	ø34

■ LW26S S3

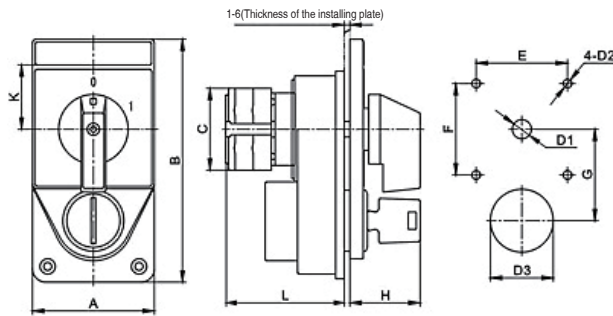

Description	Dimensions (mm)							Installation (mm)					
	A	B	K	C	L	H	E	F	G	D1	D2	D3	
LW26S-20	64	126.5	32	43	51.5	34	48	48	48	ø10	ø4.5	ø34	
LW26S-25	64	126.5	32	45.5	58	34	48	48	48	ø10	ø4.5	ø34	
LW26S-32	64	126.5	32	58	72	34	48	48	48	ø10	ø4.5	ø34	
LW26S-32F	64	126.5	32	48	61.5	34	48	48	48	ø10	ø4.5	ø34	
LW26S-63	64	126.5	32	66	79	34	48	48	48	ø10	ø4.5	ø34	



1

**Selection of typical contact diagrams**

Function	Usage code or charcter code	Marks of plate	Contact diagrams																																																																																																																																												
Start and run of motor	Q		<table border="1"> <thead> <tr> <th colspan="2">Position</th> <th>0</th> <th>1</th> </tr> <tr> <th colspan="2">Contact</th> <th></th> <th></th> </tr> </thead> <tbody> <tr> <td>1</td> <td>2</td> <td></td> <td>×</td> </tr> <tr> <td>3</td> <td>4</td> <td></td> <td>×</td> </tr> <tr> <td>5</td> <td>6</td> <td></td> <td>×</td> </tr> </tbody> </table>	Position		0	1	Contact				1	2		×	3	4		×	5	6		×																																																																																																																								
Position		0	1																																																																																																																																												
Contact																																																																																																																																															
1	2		×																																																																																																																																												
3	4		×																																																																																																																																												
5	6		×																																																																																																																																												
Start and run and reversing of motor	N		<table border="1"> <thead> <tr> <th colspan="2">Position</th> <th>1</th> <th>0</th> <th>2</th> </tr> <tr> <th colspan="2">Contact</th> <th></th> <th></th> <th></th> </tr> </thead> <tbody> <tr> <td>1</td> <td>2</td> <td></td> <td></td> <td>×</td> </tr> <tr> <td>3</td> <td>4</td> <td>×</td> <td></td> <td></td> </tr> <tr> <td>5</td> <td>6</td> <td>×</td> <td></td> <td></td> </tr> <tr> <td>7</td> <td>8</td> <td></td> <td></td> <td>×</td> </tr> <tr> <td>9</td> <td>10</td> <td>×</td> <td></td> <td>×</td> </tr> </tbody> </table>	Position		1	0	2	Contact					1	2			×	3	4	×			5	6	×			7	8			×	9	10	×		×																																																																																																									
Position		1	0	2																																																																																																																																											
Contact																																																																																																																																															
1	2			×																																																																																																																																											
3	4	×																																																																																																																																													
5	6	×																																																																																																																																													
7	8			×																																																																																																																																											
9	10	×		×																																																																																																																																											
Two speed motor startand run of motor	S		<table border="1"> <thead> <tr> <th colspan="2">Position</th> <th>1</th> <th>0</th> <th>2</th> </tr> <tr> <th colspan="2">Contact</th> <th></th> <th></th> <th></th> </tr> </thead> <tbody> <tr> <td>1</td> <td>2</td> <td>×</td> <td></td> <td></td> </tr> <tr> <td>3</td> <td>4</td> <td></td> <td></td> <td>×</td> </tr> <tr> <td>5</td> <td>6</td> <td></td> <td></td> <td>×</td> </tr> <tr> <td>7</td> <td>8</td> <td>×</td> <td></td> <td></td> </tr> <tr> <td>9</td> <td>10</td> <td></td> <td></td> <td>×</td> </tr> <tr> <td>11</td> <td>12</td> <td></td> <td></td> <td>×</td> </tr> <tr> <td>13</td> <td>14</td> <td>×</td> <td></td> <td></td> </tr> <tr> <td>15</td> <td>16</td> <td></td> <td></td> <td>×</td> </tr> </tbody> </table>	Position		1	0	2	Contact					1	2	×			3	4			×	5	6			×	7	8	×			9	10			×	11	12			×	13	14	×			15	16			×																																																																																										
Position		1	0	2																																																																																																																																											
Contact																																																																																																																																															
1	2	×																																																																																																																																													
3	4			×																																																																																																																																											
5	6			×																																																																																																																																											
7	8	×																																																																																																																																													
9	10			×																																																																																																																																											
11	12			×																																																																																																																																											
13	14	×																																																																																																																																													
15	16			×																																																																																																																																											
Two speed start andrun and reversing of motor	SN		<table border="1"> <thead> <tr> <th colspan="2">Position</th> <th>135°</th> <th>90°</th> <th>45°</th> <th>0°</th> <th>45°</th> <th>90°</th> <th>135°</th> <th>180°</th> </tr> <tr> <th colspan="2">Contact</th> <th></th> <th></th> <th></th> <th></th> <th></th> <th></th> <th></th> <th></th> </tr> </thead> <tbody> <tr> <td>1</td> <td>2</td> <td></td> <td>×</td> <td></td> <td></td> <td></td> <td></td> <td></td> <td></td> </tr> <tr> <td>3</td> <td>4</td> <td></td> <td></td> <td>×</td> <td></td> <td></td> <td></td> <td></td> <td></td> </tr> <tr> <td>5</td> <td>6</td> <td></td> <td>×</td> <td></td> <td></td> <td></td> <td></td> <td></td> <td></td> </tr> <tr> <td>7</td> <td>8</td> <td></td> <td></td> <td></td> <td>×</td> <td></td> <td></td> <td></td> <td></td> </tr> <tr> <td>9</td> <td>10</td> <td>×</td> <td></td> <td></td> <td></td> <td></td> <td></td> <td></td> <td></td> </tr> <tr> <td>11</td> <td>12</td> <td>×</td> <td></td> <td></td> <td></td> <td></td> <td></td> <td></td> <td></td> </tr> <tr> <td>13</td> <td>14</td> <td></td> <td>×</td> <td></td> <td></td> <td></td> <td></td> <td></td> <td></td> </tr> <tr> <td>15</td> <td>16</td> <td></td> <td></td> <td>×</td> <td></td> <td></td> <td></td> <td></td> <td></td> </tr> <tr> <td>17</td> <td>18</td> <td></td> <td></td> <td></td> <td>×</td> <td></td> <td></td> <td></td> <td></td> </tr> <tr> <td>19</td> <td>20</td> <td>×</td> <td></td> <td></td> <td></td> <td></td> <td></td> <td></td> <td></td> </tr> <tr> <td>21</td> <td>22</td> <td>×</td> <td></td> <td></td> <td></td> <td></td> <td></td> <td></td> <td></td> </tr> <tr> <td>23</td> <td>24</td> <td></td> <td></td> <td></td> <td></td> <td>×</td> <td></td> <td></td> <td></td> </tr> </tbody> </table>	Position		135°	90°	45°	0°	45°	90°	135°	180°	Contact										1	2		×							3	4			×						5	6		×							7	8				×					9	10	×								11	12	×								13	14		×							15	16			×						17	18				×					19	20	×								21	22	×								23	24					×			
Position		135°	90°	45°	0°	45°	90°	135°	180°																																																																																																																																						
Contact																																																																																																																																															
1	2		×																																																																																																																																												
3	4			×																																																																																																																																											
5	6		×																																																																																																																																												
7	8				×																																																																																																																																										
9	10	×																																																																																																																																													
11	12	×																																																																																																																																													
13	14		×																																																																																																																																												
15	16			×																																																																																																																																											
17	18				×																																																																																																																																										
19	20	×																																																																																																																																													
21	22	×																																																																																																																																													
23	24					×																																																																																																																																									
7 position with 0 position	H5881/3		<table border="1"> <thead> <tr> <th colspan="2">Position</th> <th>0</th> <th>1</th> <th>2</th> <th>3</th> <th>4</th> <th>5</th> <th>6</th> </tr> <tr> <th colspan="2">Contact</th> <th></th> <th></th> <th></th> <th></th> <th></th> <th></th> <th></th> </tr> </thead> <tbody> <tr> <td>1</td> <td>2</td> <td></td> <td>×</td> <td></td> <td></td> <td></td> <td></td> <td></td> </tr> <tr> <td>3</td> <td>4</td> <td></td> <td></td> <td>×</td> <td></td> <td></td> <td></td> <td></td> </tr> <tr> <td>5</td> <td>6</td> <td></td> <td></td> <td></td> <td>×</td> <td></td> <td></td> <td></td> </tr> <tr> <td>7</td> <td>8</td> <td></td> <td></td> <td></td> <td></td> <td>×</td> <td></td> <td></td> </tr> <tr> <td>9</td> <td>10</td> <td></td> <td></td> <td></td> <td></td> <td></td> <td>×</td> <td></td> </tr> <tr> <td>11</td> <td>12</td> <td></td> <td></td> <td></td> <td></td> <td></td> <td></td> <td>×</td> </tr> </tbody> </table>	Position		0	1	2	3	4	5	6	Contact									1	2		×						3	4			×					5	6				×				7	8					×			9	10						×		11	12							×																																																																				
Position		0	1	2	3	4	5	6																																																																																																																																							
Contact																																																																																																																																															
1	2		×																																																																																																																																												
3	4			×																																																																																																																																											
5	6				×																																																																																																																																										
7	8					×																																																																																																																																									
9	10						×																																																																																																																																								
11	12							×																																																																																																																																							
3 phase voltmeter with 0 position	YH5/3		<table border="1"> <thead> <tr> <th colspan="2">Position</th> <th>CA</th> <th>BC</th> <th>AB</th> <th>0</th> <th>A</th> <th>B</th> <th>C</th> </tr> <tr> <th colspan="2">Contact</th> <th></th> <th></th> <th></th> <th></th> <th></th> <th></th> <th></th> </tr> </thead> <tbody> <tr> <td>1</td> <td>2</td> <td></td> <td>×</td> <td></td> <td></td> <td></td> <td></td> <td>×</td> </tr> <tr> <td>3</td> <td>4</td> <td>×</td> <td></td> <td></td> <td></td> <td></td> <td></td> <td></td> </tr> <tr> <td>5</td> <td>6</td> <td></td> <td></td> <td>×</td> <td></td> <td></td> <td></td> <td></td> </tr> <tr> <td>7</td> <td>8</td> <td>×</td> <td>×</td> <td></td> <td></td> <td></td> <td></td> <td></td> </tr> <tr> <td>9</td> <td>10</td> <td></td> <td></td> <td></td> <td>×</td> <td></td> <td></td> <td></td> </tr> <tr> <td>11</td> <td>12</td> <td></td> <td></td> <td></td> <td></td> <td>×</td> <td>×</td> <td>×</td> </tr> </tbody> </table>	Position		CA	BC	AB	0	A	B	C	Contact									1	2		×					×	3	4	×							5	6			×					7	8	×	×						9	10				×				11	12					×	×	×																																																																				
Position		CA	BC	AB	0	A	B	C																																																																																																																																							
Contact																																																																																																																																															
1	2		×					×																																																																																																																																							
3	4	×																																																																																																																																													
5	6			×																																																																																																																																											
7	8	×	×																																																																																																																																												
9	10				×																																																																																																																																										
11	12					×	×	×																																																																																																																																							

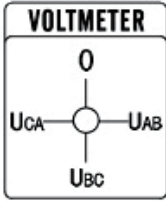
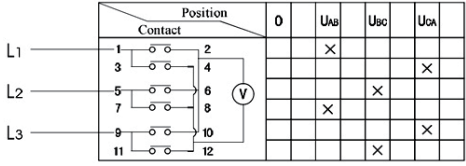
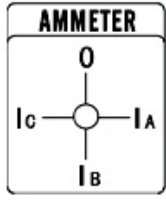
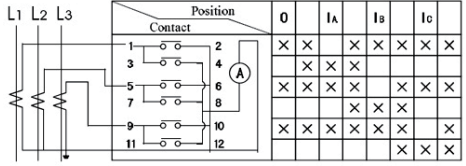

**Selection of typical contact diagrams**

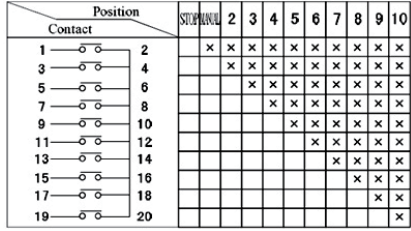
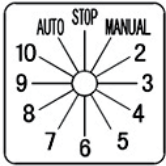
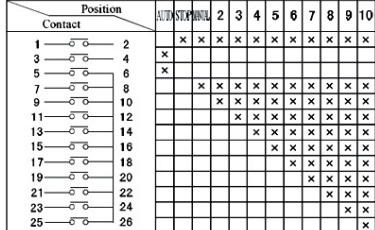
Function	Usage code or charcter code	Marks of plate	Contact diagrams
Three phase voltmeter with 0 position	YH3/3		
Three phase ammeter with 0 position	LH3/3		
11 positions with 0 position step by step change over	L6560/5		
12 positions with 0 and auto position step by step change over	TM707/7		
3 position with 0, auto and manual change over	TD710/6	