

Features:

- 600V volts rating (R.M.S.)
- Thickness: 0.2mm

Specifications:

- Voltage rating: 600V AC, DC
- Current rating up to 9A(with #18 AWG)
- Dielectric withstanding Voltage: 1500V AC/minute
- Contact resistance: Initial value/10mΩ max.
After environmental testing/20mΩ max.
- Crimp resistance: 5mΩ max,
- Terminal retention force: 3.0Kg min.
- Ambient temperature range: -40°C ~ 105°C
(including temperature rise)

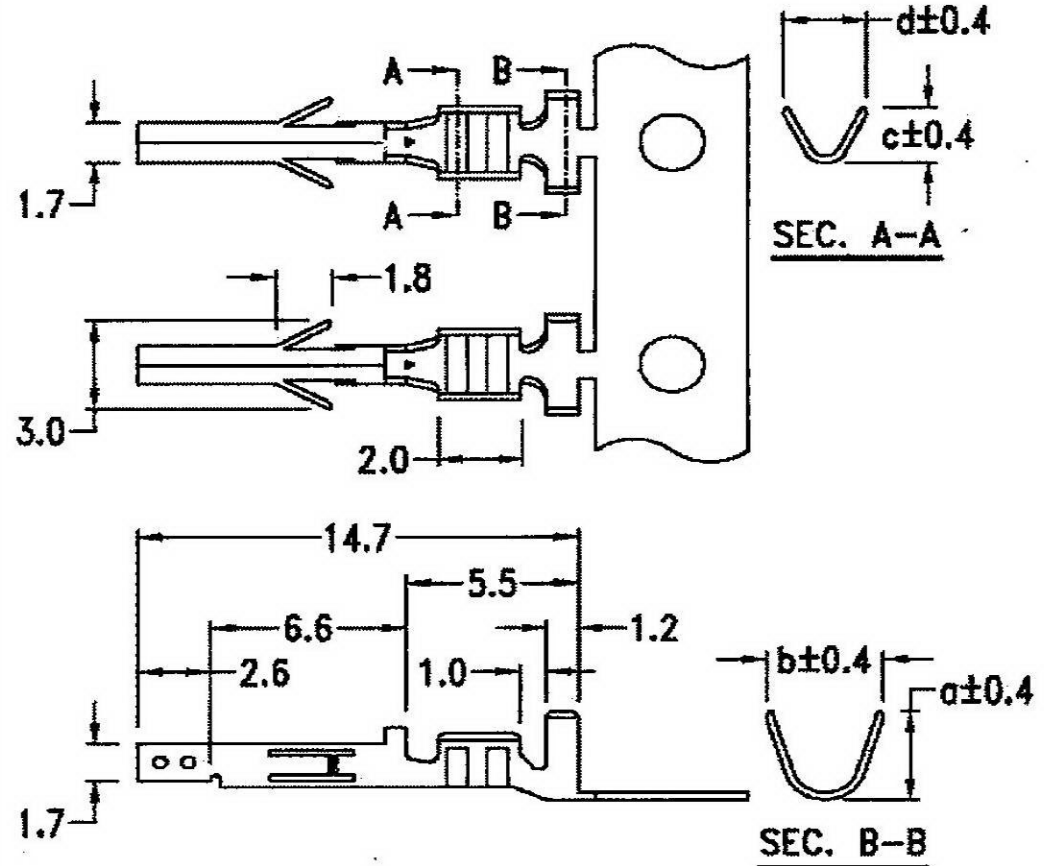

Ordering & Dimensional Information (mm) :

Dimension				Wire Size	Material	Finished
a	b	c	d	(AWG)		
2.3	2.3	1.65	1.8	#22 ~ #28	BRASS	Tin-plated
4.5	3.6	2.3	1.9	#18 ~ #24		
		2.8	2.4	#16		

RoHS
Compliant

APPD.
核准

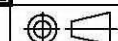

TOLERANCE
容許公差

PART NAME 品名

DWG.
製圖

HELEN

SCALE
比例 參考

0 ±0.40
.00 ±0.25
ANG ±

4.2mm FEMALE TERMINAL BRASS MATERIAL
TIN PLATING 1ROLL=10K PCS
ROHS LOW-LEAD

DATE 制表日

2009/3/27

PAGE
張數 1 OF 1

UNIT
單位 M M
REV.
版本 A

PART NO.

料號 T5150-TBX00000R