

- Material acc. to DIN 176: 11 SMn Pb30
- Minimum tensile strength: 500 N/ mm<sup>2</sup>
- Surface finish acc. to DIN 267: galvanised (A3 F)
- Material number: 1.0718
- Tolerance for length dimensions +/- 0.1 mm (DIN 2768-m applies to SW13)
- All articles are also available without undercut.

- Available from stock. Delivery times for intermediate lengths and special versions upon request.



## Standard range spacer bolts [ Znc, plated ]

EXECUTION DIA [ Internal / external thread ]

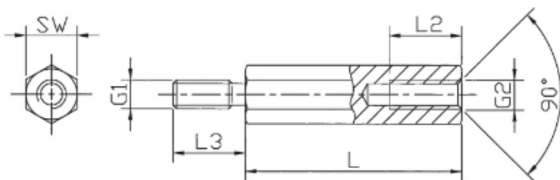

Internal thread lengths [ mm ]

| L       | L2 at M2.5 □ M5 | L2 at M2 | L2 at M6 | L2 at M8 |
|---------|-----------------|----------|----------|----------|
| 5       | 3               | 3        |          |          |
| 8       | 5               | 5        |          |          |
| 10      | 6               | 6        | 6        |          |
| 12      | 7               | 6        | 7        |          |
| 15      | 10              | 6        | 10       | 10       |
| 18      | 10              | 6        | 10       |          |
| from 20 | 10              | 6        | 12       | 14       |

External thread lengths [ mm ]

| G1=G2 | L3 |
|-------|----|
| M2    | 5  |
| M2,5  | 6  |
| M3    | 6  |
| M4    | 8  |
| M5    | 8  |
| M6    | 10 |
| M8    | 14 |

| Order No.      | Execution | Material | SW* (hexagon) | Thread | Standard lengths in mm  |
|----------------|-----------|----------|---------------|--------|---|
| 221 x (length) | DIA       | Steel    | SW4           | M2     | 5, 8, 10, 12, 15, 18, 20, 25, 30, 35, 40  |
| 2212 x         | DIA       | Steel    | SW4           | M2.5   | 5, 8, 10, 12, 15, 18, 20, 25, 30, 35, 40  |
| 223 x          | DIA       | Steel    | SW5           | M3     | 5, 8, 10, 12, 15, 18, 20, 25, 30, 35, 40, 45, 50  |
| 224 x          | DIA       | Steel    | SW5.5         | M3     | 5, 8, 10, 12, 15, 18, 20, 25, 30, 35, 40, 45, 50, 55, 60, 65, 70                          |
| 225 x          | DIA       | Steel    | SW6           | M3     | 5, 8, 10, 12, 15, 18, 20, 25, 30, 35, 40, 45, 50, 55, 60, 65, 70, 75, 80, 85, 90, 95, 100 |
| 226 x          | DIA       | Steel    | SW7           | M4     | 5, 8, 10, 12, 15, 18, 20, 25, 30, 35, 40, 45, 50, 55, 60, 65, 70, 75, 80, 85, 90, 95, 100 |
| 227 x          | DIA       | Steel    | SW8           | M4     | 5, 8, 10, 12, 15, 18, 20, 25, 30, 35, 40, 45, 50, 55, 60, 65, 70, 75, 80, 85, 90, 95, 100 |
| 228 x          | DIA       | Steel    | SW8           | M5     | 8, 10, 12, 15, 18, 20, 25, 30, 35, 40, 45, 50, 55, 60, 65, 70, 75, 80, 85, 90, 95, 100    |
| 229 x          | DIA       | Steel    | SW10          | M6     | 10, 12, 15, 18, 20, 25, 30, 35, 40, 45, 50, 55, 60, 65, 70, 75, 80, 85, 90, 95, 100       |
| 2213 x         | DIA       | Steel    | SW13          | M8     | 15, 20, 25, 30, 35, 40, 45, 50, 55, 60, 65, 70, 75, 80, 85, 90, 95, 100                   |

\*SW: width across flats

Ordering example: 229 x 50 = DIA/ St / SW10 / M6 x 50

