

SR 022系列 SR 022 SERIES

特点及应用

导电滑环属于电接触滑动连接应用范畴，它又称集电环、或称旋转关节、旋转电气接口、滑环、集流环、回流环、线圈、换向器、转换器，是实现两个相对转动机构的图像、数据信号及动力传递的精密输电装置。特别适合应用于无限制的连续旋转，同时又需要从固定位置到旋转位置传递功率或数据的场所。其由导电材料—电刷、滑动触点表面材料—导电环、绝缘材料、粘接材料等组成。电刷采用贵金属合金材料，呈“U”型与导电环槽对称双接触，借助电刷的弹性压力与导电环槽滑动接触来传递信号及电流。是各种精密转台、离心机和惯导设备的关键器件。可广泛应用于安防、工厂自动化、电力、金融、仪表、化工、冶金、医疗、航空、军事、船舶、运输、建筑等机电设备上。

Description

The slip ring can be used in any electro-mechanical system that requires unrestrained, continuous rotation while transmitting power and / or data from a stationary to a rotating structure. The slip ring is also called a rotary electrical interface, commutator, collector, swivel or an electrical rotary joint. The brush adopt noble metal alloy material, Conducting Ring Using a 900V-grooving ring. It adopt multilayer noble metal alloy for plating dispose. Color-coded lead wires are used on both the stator and rotor for simplified electrical connections.

The SRC Series find typical applications in

- ※ CCTV pan/tilt cameras and pedestals
- ※ Robots and downhole inspection equipment
- ※ Test and measuring equipment
- ※ Manufacturing and process control equipment
- ※ Computer peripherals
- ※ Display equipment Medical equipment

规格表 Specification List

型号 Model	环数 #Rings	连续电流 Continuous current (amp)			外径 × 长度 DIA" × LG"
		2	6	10	
SR022系列 (SR022 SERIES)					
SR022-6	6	6			Φ22 × 19
SR022-12	12	12			Φ22 × 28
SR022-12-2P/2S	4	2	2		Φ22 × 28
SR022-15	15	2			Φ22 × 29.5
SR022-18	18	18			Φ22 × 33.4
SR022-18-3P	3			3	Φ22 × 33.4
SR022-24	24	24			Φ22 × 41.2
SR022-24-4P/6S	10	6	4		Φ22 × 41.2

机械技术指标 Mechanical data

参数	Specification	单位	Unit
工作速度	Operate Speed	250rpm	
温度范围	Temperature range	-20℃~+80℃	
接触材料表面	Contact material surface	金-金	Gold-gold
轴承	The steel bearing	精密小滚珠轴承	The precise small steel ball bearing

滑环寿命由工作转速，工作环境和温度决定

The life of the slip ring is decided by the rotating speed, working environment and temperature.

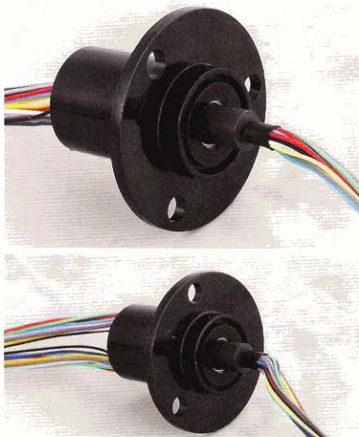

电气技术指标 Electric data

参数	Specification	单位	Unit
电压	Voltage	240VDC~240VAC	
电流	Current	标准每环为2A, 2环合并得4A, 可按客户要求生产 Standard 2A/ring, 2 rings combined 4A, can be produced according to customer's request	
导线大小	Lead size	AWG28, AWG26, 2A; AWG22-6A, AWG16-10A AWG28彩色铁氟龙绝缘导线 Color coded PTFE insulated lead wires	
导线长度	Standard Lead length	250mm或根据客户要求提供 250mm (other lengths on request)	
绝缘体强度	High pot	500VAC @ 60Hz, 60s	
绝缘电阻	Insulation Resistance	1000MΩ/500VDC	
动态接触电阻变化值	Dynamic contact Resistance	< 0.01Ω	

可按客户要求订制各种滑环，也可提供OEM产品

Manufacture slip ring according to customer's request, we also welcome OEM to join us.

型号 Type

外形尺寸 Outline dimension 单位 (Unit)mm



标准型(standard) SR022

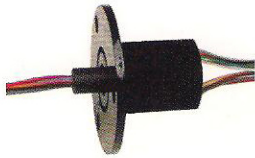
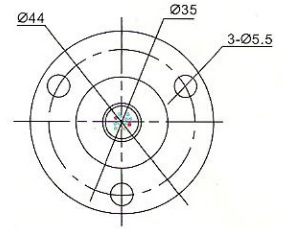
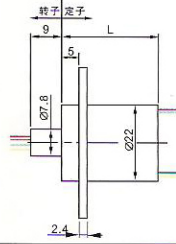

A型("A"Model) SR022A

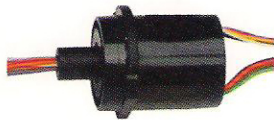
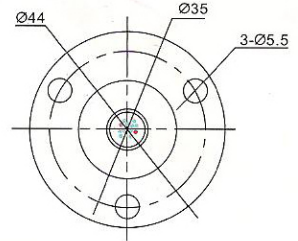
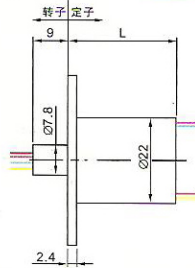

B型("B"Model) SR022B

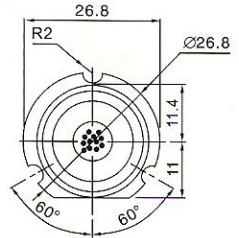
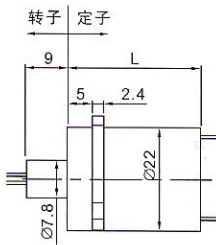

C型("C"Model) SR022C

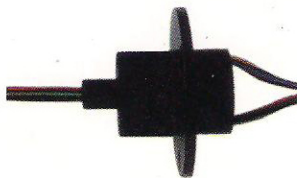
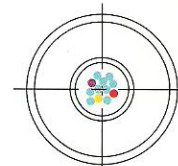
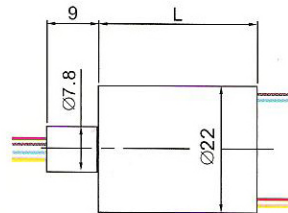

仅限于12环 Only limit to 6、12 rings
D型("D"Model) SR022D

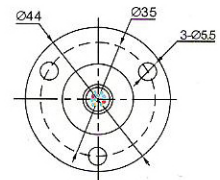
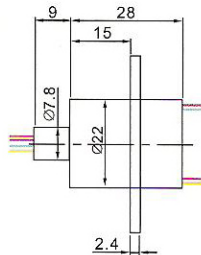

仅限于6、12环 Only limit to 6、12 rings
E型("E"Model) SR020E

