

PART File/Edition: TS013-S(160/260/320/520)B2C(43/50)C

XX.XX	CONTROL DIMENSION
△	CRITICAL CHARACTERISTIC

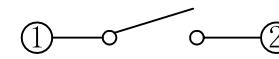

原理图

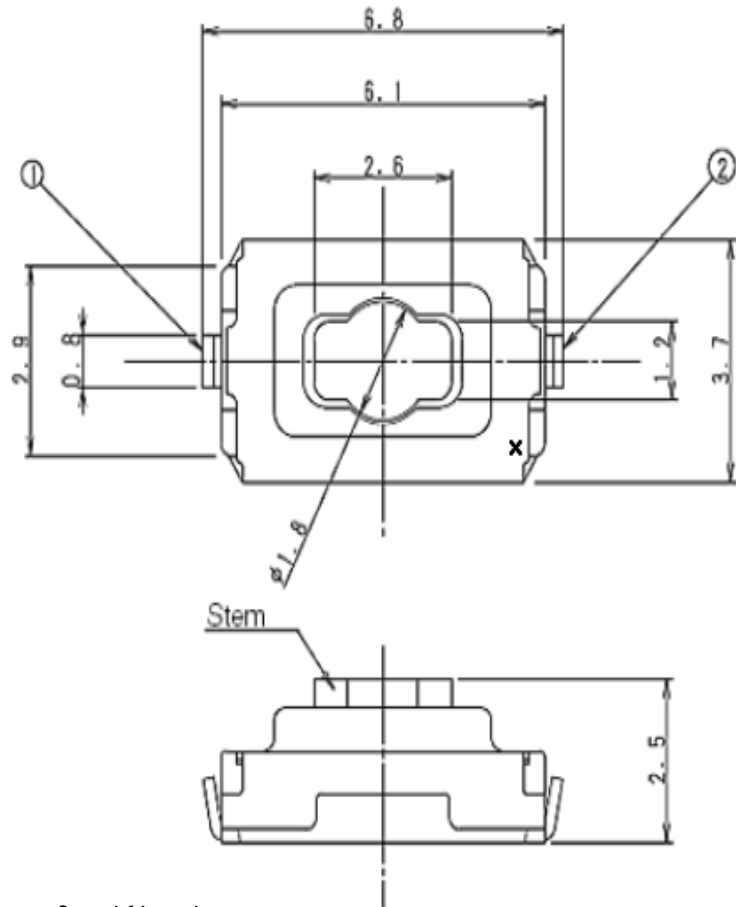
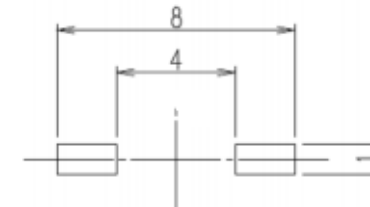

安装参考图

Specifications

1. Rating(max) :50mA 12V DC
2. Contact resistance : 500m max
3. Insulation resistance: 100 m min
4. Operating Force: 300 ± 50gf
5. Operating Life: 50000 cycles
6. Travel: 0.25 ± 0.1mm
7. Switch feel is obvious, clear and reliable gear, no block phenomenon, after elimination of external forces, it should be able to return quickly.

REV.	DATE	MODIFICATION	ECN NO.					PRIOR VERSION
Title/Proj.		TS013-S(160/260/320/520)B2C(43/50)C	Tolerance Unless Otherwise Specified					
Part No		Version	~3	>3-6	>6-10	>10-18	>18-30	Angle
Drawing No	---	Scale	±0.05	±0.06	±0.08	±0.10	±0.12	±2°
Drafted by		Date	Unit: mm		Size: A4			
Checked by		Date	THIRD ANGLE					
Approved by		Date						