

Brief introduction of products

- Stable working temperature
- Clear-cut action without extending spring, less interference with wireless
- Imported raw material, wet-resistant & heat-resisting
- Automatic Reset/Manual Reset
- High precision, steady performance, good synchronism
- Widely used in devices for many kind of household appliance

Technical Parameters

- Electric Parameters: AC250V 5A/10A/16A AC120V 7A
- Temperature Range: $-25^{\circ}\text{C} \sim +195^{\circ}\text{C} +1^{\circ}\text{C} \sim 2^{\circ}\text{C}$
- (according to customers' requirement)
- Working Life: more than 100000 times
- Resistance: $>100\text{M}$



KSD301A-118C

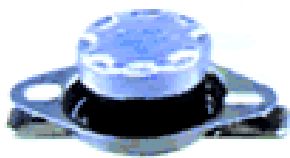
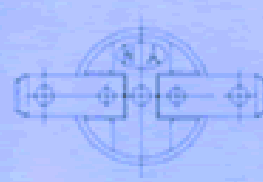
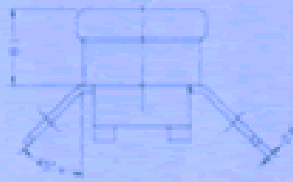

KSD301A-A324

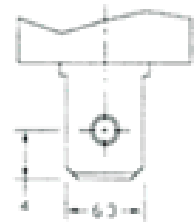
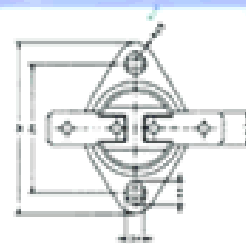
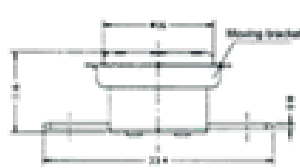

KSD301A-A323

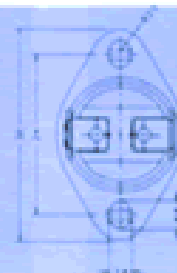
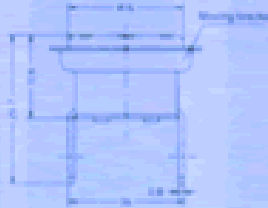

KSD301A-A114

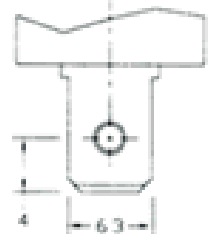
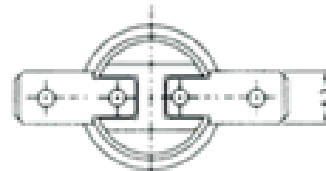
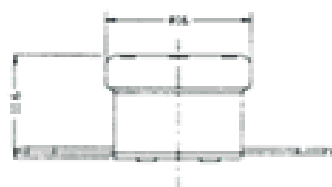

KSD301A-A334

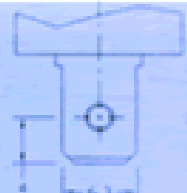
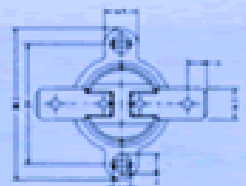

KSD301A-A316

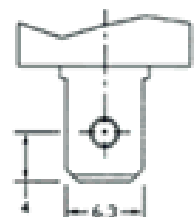
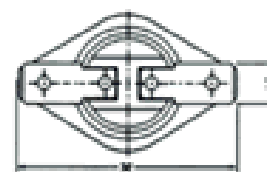
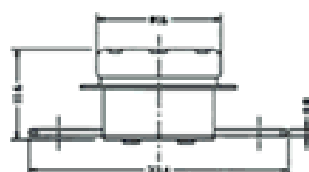

KSD301A-A314

