

LAY5

Control box series

Model and meaning

Button box part:

LAY 5 - B.J P / H

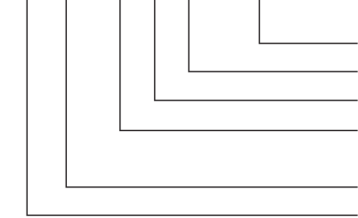

Optional, with "H" denotes higher in height
Means holes in control box

The type of Button box

"B" in it denotes grey cover shall be fitted with black base,
"J" in it denotes yellow cover shall be fitted with black base

Design sequence number

Push button and Signal lamp

Button box:

LAY 5 - B.J H29

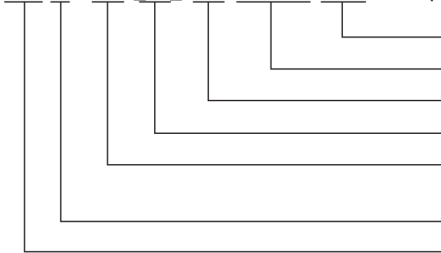

The code of label type

The code of push button symbol

Means holes in control box

Means the outlize of the control box

"B" in it denotes grey cover shall be under black base,

"J" in it denotes yellow cover shall be under black base

Design sequence number

Push button and signal lamp

SIZE

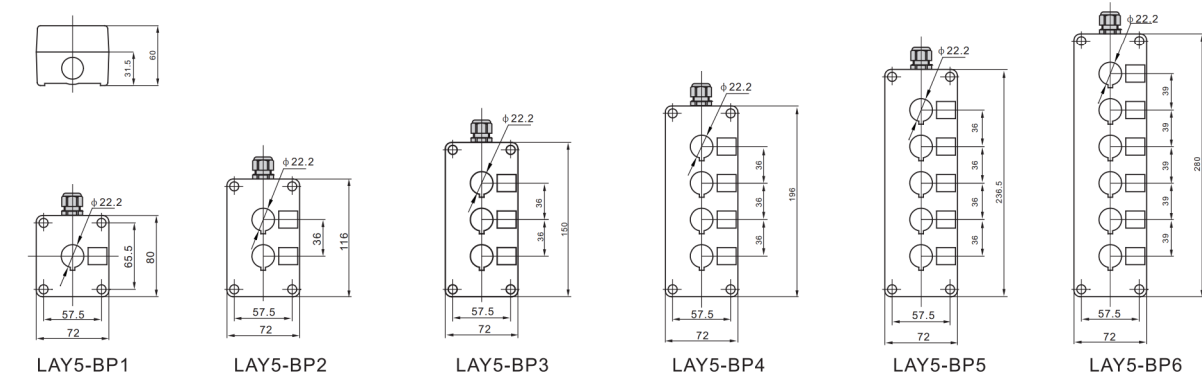
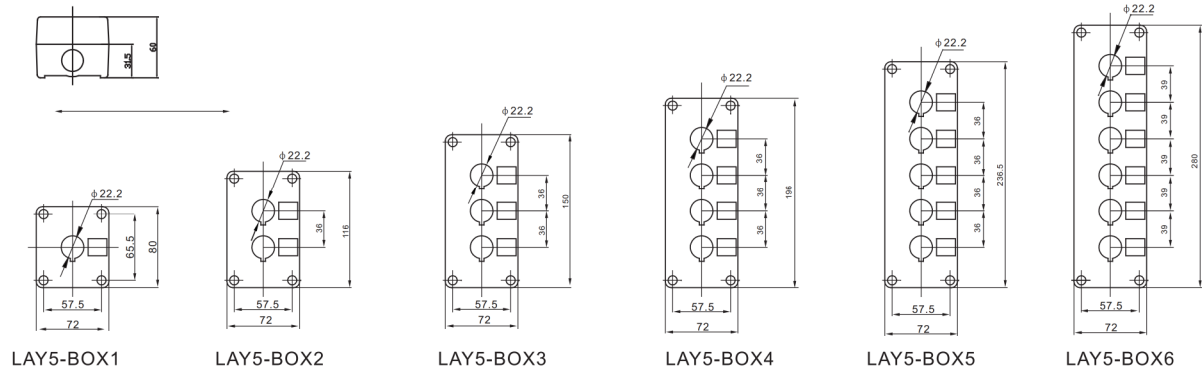

LAY5

Control box series



SIZE

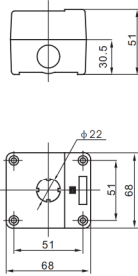

LAY5-BE01

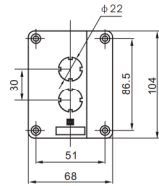

LAY5-BE01

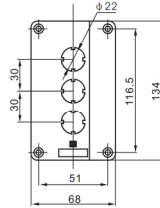

LAY5-BE01

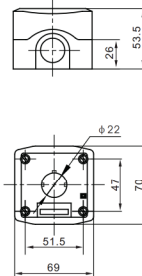

LAY5-BEN1

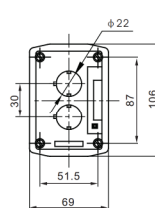

LAY5-BEN2

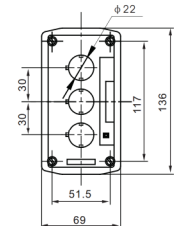

LAY5-BEN3

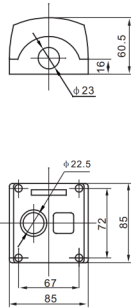

LAY5-BOE1

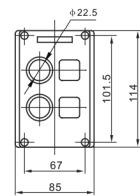

LAY5-BOE2

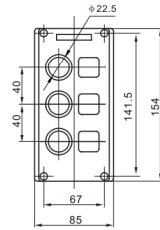

LAY5-BOE3

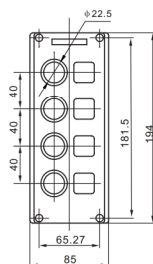

LAY5-BOE4

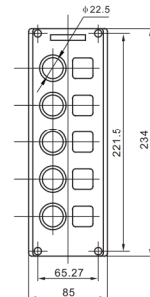

LAY5-BOE5

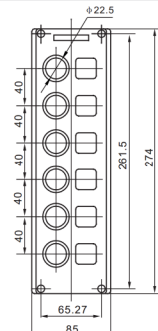

LAY5-BOE6

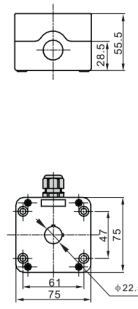

LAY5-JBPN1

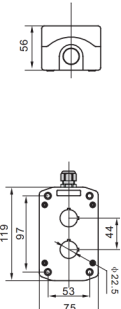

LAY5-JBPN2

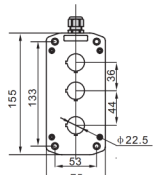

LAY5-JBPN3

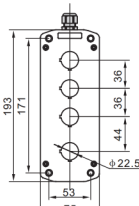

LAY5-JBPN4

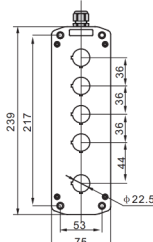

LAY5-JBPN5

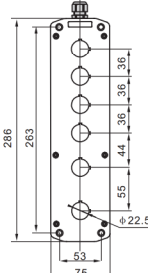

LAY5-JBPN6

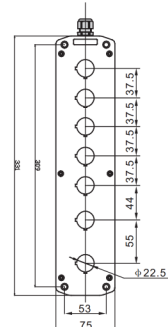

LAY5-JBPN7

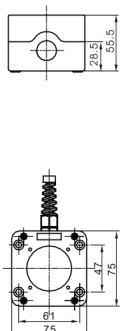

LAY5-JBPH1

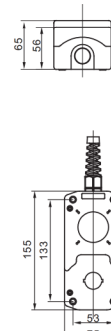

LAY5-JBPH2

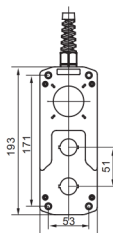

LAY5-JBPH3

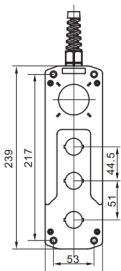

LAY5-JBPH4

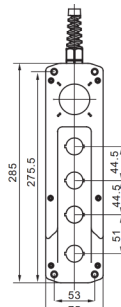



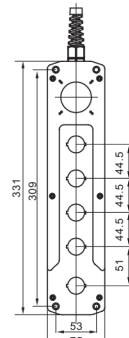





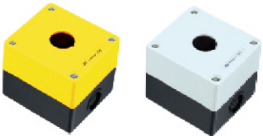
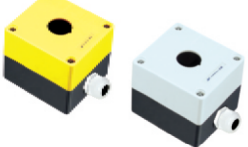

LAY5-JBPH5



LAY5-JBPH6

LAY5

Control box series

Parts	Description	Type	Parts	Description	Type
 LAY5-JBOX1 LAY5-BOX1	Button box for single hole IP40 $\phi 22$ $\phi 25$	LAY5-BOX1 LAY5-JBOX1	 LAY5-JBP01 LAY5-BP01	Button box for single hole IP40/54 $\phi 22$ $\phi 25$	LAY5-JBP01 LAY5-BP01
 LAY5-BOX2	Button box for two holes IP40 $\phi 22$ $\phi 25$	LAY5-BOX2	 LAY5-BP02	Button box for two holes IP40/54 $\phi 22$ $\phi 25$	LAY5-BP02
 LAY5-BOX3	Button box for three holes IP40 $\phi 22$ $\phi 25$	LAY5-BOX3	 LAY5-BP03	Button box for three holes IP40/54 $\phi 22$ $\phi 25$	LAY5-BP03
 LAY5-BOX4	Button box for four holes IP40 $\phi 22$ $\phi 25$	LAY5-BOX4	 LAY5-BP04	Button box for four holes IP40/54 $\phi 22$ $\phi 25$	LAY5-BP04
 LAY5-BOX5	Button box for five holes IP40 $\phi 22$ $\phi 25$	LAY5-BOX5	 LAY5-BP05	Button box for five holes IP40/54 $\phi 22$ $\phi 25$	LAY5-BP05
 LAY5-BOX6	Button box for six holes IP40 $\phi 22$ $\phi 25$	LAY5-BOX6	 LAY5-BP06	Button box for six holes IP40/54 $\phi 22$ $\phi 25$	LAY5-BP06

LAY5







Control box series



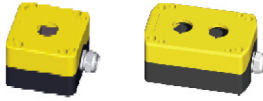



Parts	Description	Type	Parts	Description	Type
 LAY5-JBE01 LAY5-BE01	Button box for single hole IP40/54 $\phi 22$	LAY5-JBE01 LAY5-BE01	 LAY5-BOE1	Button box for single hole IP54	LAY5-BOE1
 LAY5-BE02	Button box for two holes IP40/54 $\phi 22$	LAY5-BE02	 LAY5-BOE2	Button box for two holes IP54	LAY5-BOE2
 LAY5-BE03	Button box for three holes IP40/54 $\phi 22$	LAY5-BE03	 LAY5-BOE3	Button box for three holes IP54	LAY5-BOE3
 LAY5-BEN1	Button box for single hole with din rail IP54 IP65 $\phi 22$	LAY5-BEN1	 LAY5-BOE4	Button box for four holes IP54	LAY5-BOE4
 LAY5-BEN2	Button box for two holes with din rail IP54 IP65 $\phi 22$	LAY5-BEN2	 LAY5-BOE5	Button box for five holes IP54	LAY5-BOE5
 LAY5-BEN3	Button box for three holes with din rail IP54 IP65 $\phi 22$	LAY5-BEN3	 LAY5-BOE6	Button box for six holes IP54	LAY5-BOE6

LAY5

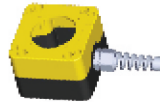
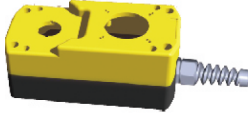
Control box series

Parts	Description	Type
 LAY5-JBPN1 LAY5-JBPN2	Button box for single and two holes IP54 IP65 $\phi 22$	LAY5-JBPN1 LAY5-JBPN2
 LAY5-JBPN3	Button box for three holes IP54 IP65 $\phi 22$	LAY5-JBPN3
 LAY5-JBPN4	Button box for four holes IP54 IP65 $\phi 22$	LAY5-JBPN4
 LAY5-JBPN5	Button box for five holes IP54 IP65 $\phi 22$	LAY5-JBPN5
 LAY5-JBPN6	Button box for six holes IP54 IP65 $\phi 22$	LAY5-JBPN6
 LAY5-JBPN7	Button box for seven holes IP54 IP65 $\phi 22$	LAY5-JBPN7

Parts	Description	Type
 LAY5-JBPH1	Button box for single hole IP54 IP65 $\phi 22$	LAY5-JBPH1
 LAY5-JBPH2	Button box for two holes IP54 IP65 $\phi 22$	LAY5-JBPH2
 LAY5-JBPH3	Button box for three holes IP54 IP65 $\phi 22$	LAY5-JBPH3
 LAY5-JBPH4	Button box for four holes IP54 IP65 $\phi 22$	LAY5-JBPH4
 LAY5-JBPH5	Button box for five holes IP54 IP65 $\phi 22$	LAY5-JBPH5
 LAY5-JBPH6	Button box for six holes IP54 IP65 $\phi 22$	LAY5-JBPH6