

Tact Switch Series

KLS7-TS6611 6x6 Tact Switch Series

ELECTRICAL

1. Rating: 50mA 12VDC
2. Contact Resistance : 50mΩ max(initial)
3. Insulation Resistance: 100MΩ(minDC 250V)
4. Dielectric Strength : AC250V(50/60Hz for 1minute)
5. Electrically Life: 100000cycles
6. Environment temperature: -20°C~+70°C
7. Operating Force: 180/250(±30gf)
8. Seal temperature: 260°C~ 280°C



H
1.5
1.7
1.9

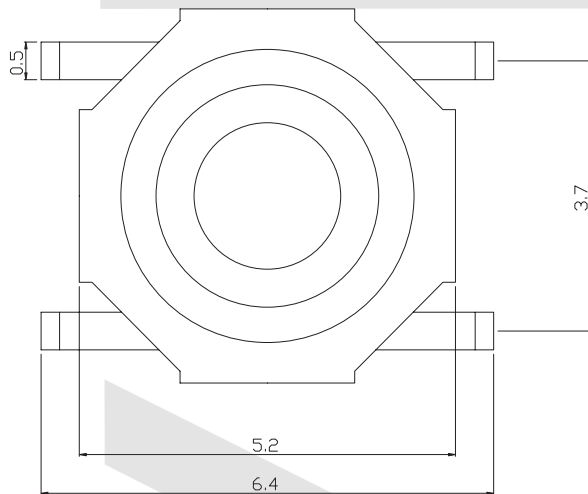
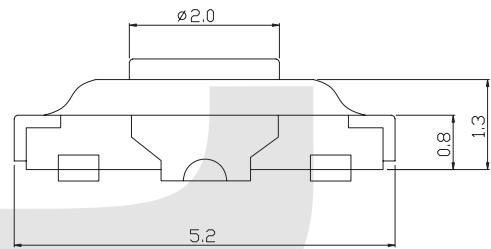
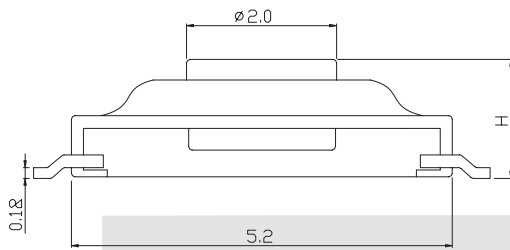

H1=1.5mm
H2=1.7mm
H3=1.9mm

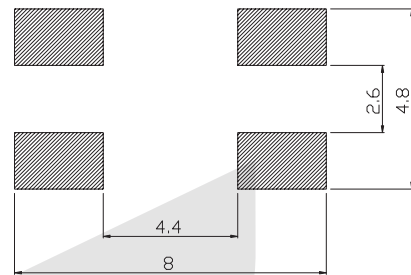

PCB LAYOUT

ORDER INFORMATION

KLS7-TS6611 - 1.5 - 180 -T

Series No.

Hight: 1.5mm/1.7mm/1.9mm

Packing: B-Bulk T-Tape

Operating Force : 180~250gf