

## SWITCH / TOGGLE SWITCH

### TB SERIES IP67 level

TB is a sealed toggle switch, waterproof, conforming to IP67 level protection.

It can built with a plastic or brass bat type actuator; 1 and 2 pole, 2 and 3 position, maintained and momentary action.

Perfectly suitable for control panels in rugged environment.



[PDF Download](#)

[Get Information](#)

 ZOOM IN

### Feature

- Contact Rating: 12 A, 125VAC/250VAC(UL,CUL)  
1HP, 250VAC; 1/2 HP, 125VAC; 5A 125VL (Tungsten) (UL,CUL)
- Contact resistance : 50m  $\Omega$  max
- Dielectric Strength: 1500 Volts RMS
- Insulation Resistance: 50 Megohms
- Life: 50,000 cycles

### Specification

- IP67 protection level for the entire switch
- Metal bat or plastic toggle
- Solder, quick connect, screw type or binding terminals
- hex nut, gasket, and rubber boot accessories available upon request.
- Operation Temperature: -40°C~ +85°C

### PANEL CUT-OUT

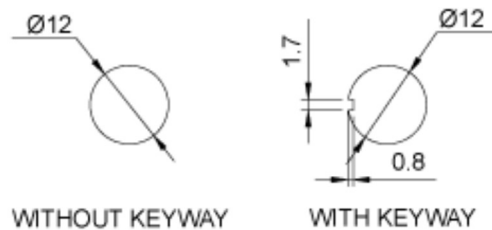

How to order:

TB1

- B

1

7

SERIES SYMBOL	LEVER	TERMINAL	POSITION & FUNCTION		
TB1 SERIES (1 POLE, 3 POS.) TB2 SERIES (1 POLE, 2 POS.) TB3 SERIES (2 POLE, 3 POS.) TB4 SERIES (2 POLE, 2 POS.)	P PLASTIC	1 QC (.250)	<b>TWO POSITIONS</b>		<b>THREE POSITIONS</b>
	B BRASS	2 QC (.187)	TB2 (1 POLE)	TB1 (1 POLE)	TB3 (2 POLES)
		3 SOLDER	*2 OFF-ON	1 ON-OFF-ON	1 ON-OFF-ON
		4 SCREW	*3 ON-ON	5 (ON)-OFF-ON	5 (ON)-OFF-ON
		*5 BINDING	4 (OFF)-ON	7 (ON)-OFF-(ON)	7 (ON)-OFF-(ON)
		6 (ON)-OFF	21 NONE-OFF-ON	21 NONE-OFF-ON	
		8 (ON)-ON	31 NONE-ON-ON	31 NONE-ON-ON	
			61 (ON)-OFF-NONE	61 (ON)-OFF-NONE	
			<b>TB4 (2 POLES)</b>	10 ON-ON-ON	12 ON-ON-ON
			*2 OFF-ON		
			*3 ON-ON		
			4 (OFF)-ON		
			6 (ON)-OFF		
			8 (ON)-ON		

NOTE: "\*" WITHOUT UL APPROVAL



Item

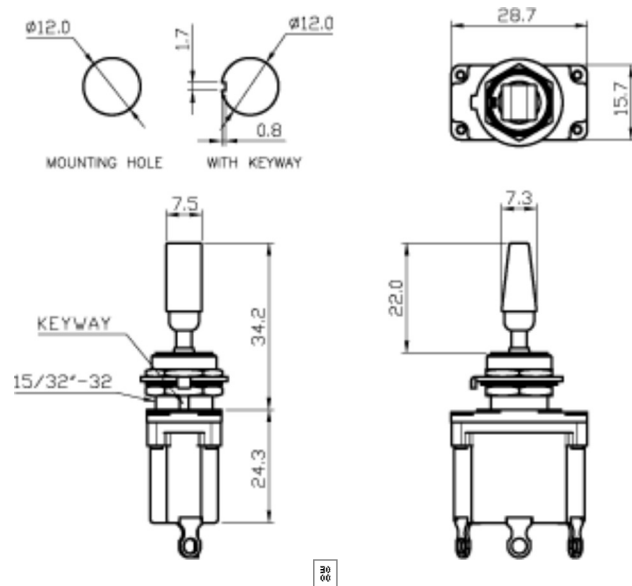

TB1-P37  
(ON)-OFF-(ON)

TB3-P17  
(ON)-OFF-(ON)

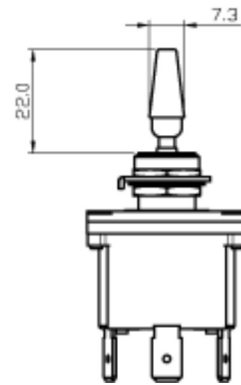
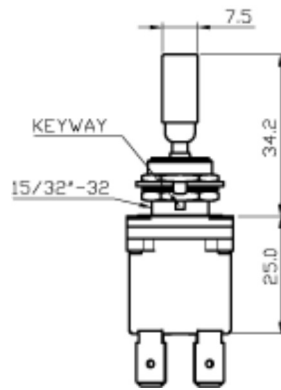
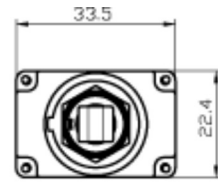
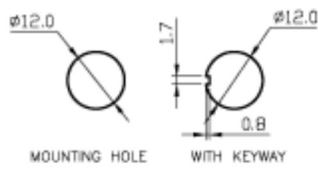

30  
60

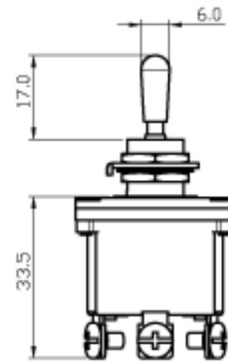
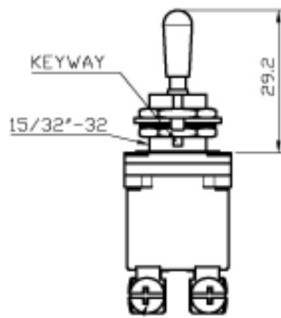
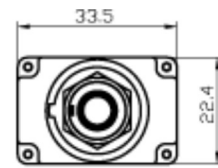
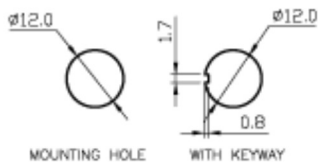

30  
60

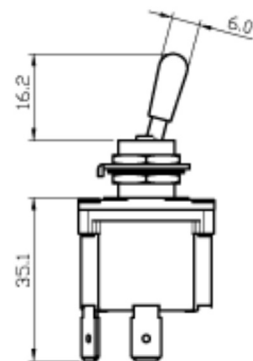
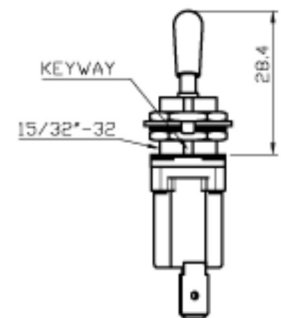
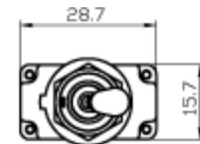
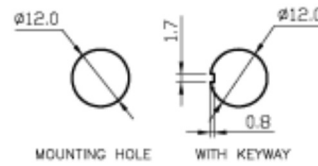

30  
60

TB3-B41  
ON-OFF-ON

TB2-B14  
(OFF)-ON

TB2-B53  
ON-ON

30  
60

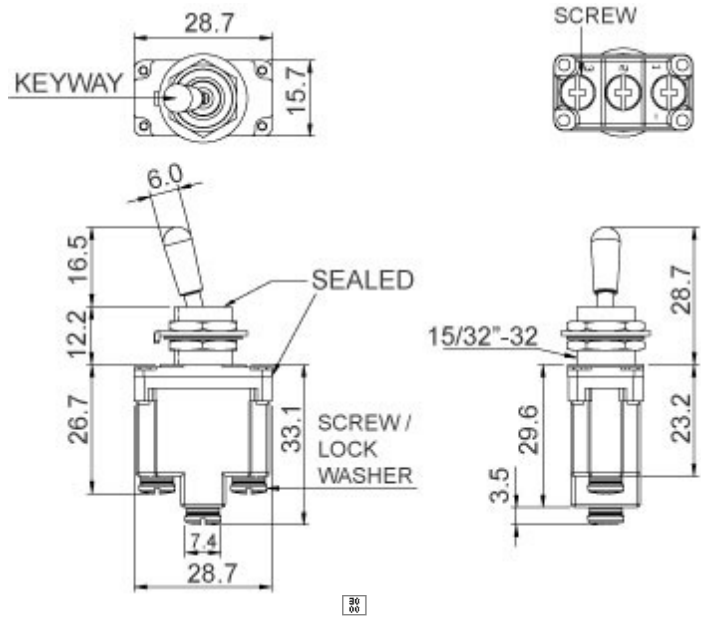

 Start Print

Canal Components Inc. Tel:+886-2-29161263 Fax:+886-2-29117574  
 Copyright ©2009 Canal Components Inc.. All rights reserved.