

**Przełącznik; suwakowy; SS12F41; ON-ON | przewlekany (THT);
R=3,0mm; 2 pozycje; 1 tor; 13,2mm; 5,9mm; 14mm; 8mm; 0,5A; 50V
DC; piny mocujące nr kat 05952**

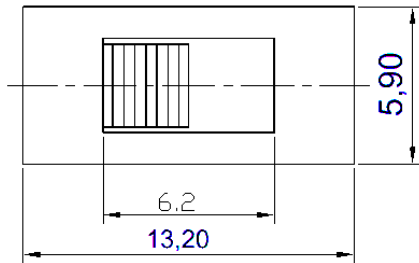

MODEL NO.	M=	N=	A=
SS-12F41	12,30	9,30	6,0

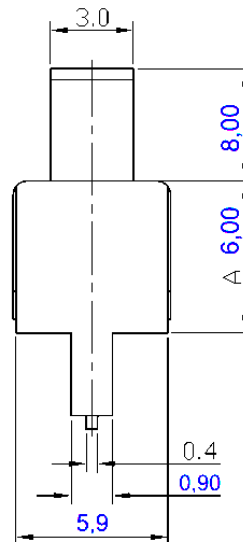
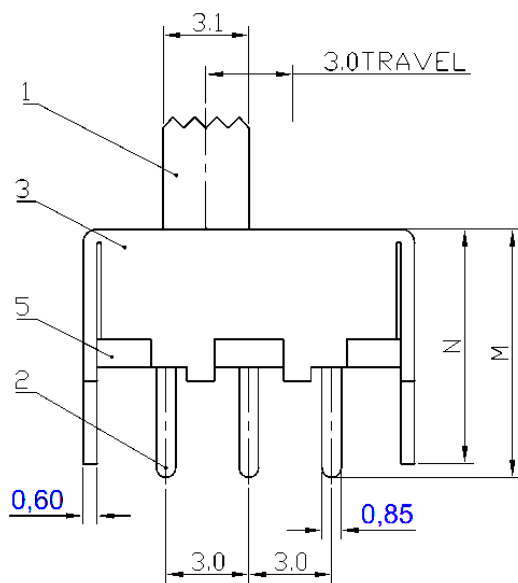

6	SPRING	STEEL WIRE	1	NATURE
5	BOARD	PHENOLIC RESIN	1	NATURE
4	CONTACT CLIP	BRASS STRIP	1	Ag PLATED
3	FRAME	IRON STRIP	1	Ni PLATED
2	TERMINAL	BRASS STRIP	3	Ag PLATED
1	KNOB	POM	1	BLACK
NO.	PART NAME	MATERIAL	QTY	FINISHING

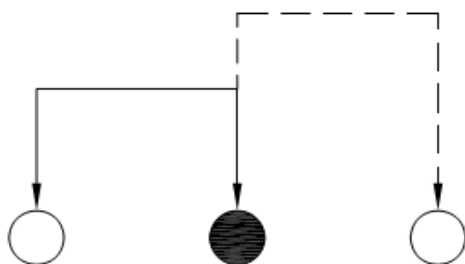

SCHEMATIC (NON-SHORTING)

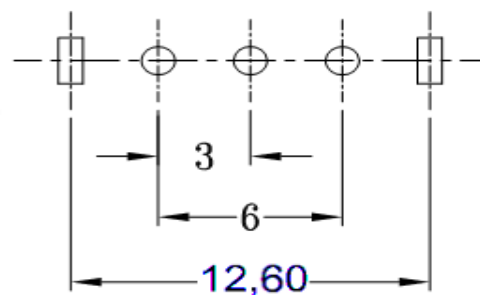

P.C.B LAYOUT