

25.208. *

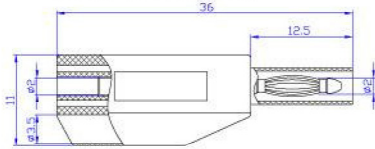

Material
 Insulator:PA
 Body:Brass
 Spring:Beryllium copper
 Surface:Nickel plated
 *Solder connection
Rated voltage/current
 CATII 600V/Max.10A



25.410. *



Material
 Insulator:PVC
 Body:Brass
 Spring:Steel
 Surface:Nickel plated
 *Screw connection
Rated voltage/current
 30Vac-60Vdc/Max.24A

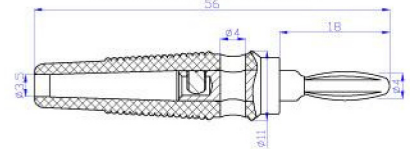

25.401. *



Material
 Insulator:ABS
 Body:Brass
 Spring:Beryllium copper
 Surface:Nickel plated
 *Screw connection
Rated voltage/current
 30Vac-60Vdc/Max.24A

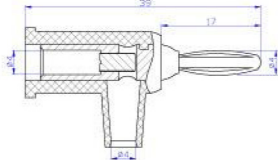

25.411. *



Material
 Insulator:PVC
 Body:Brass
 Spring:Steel
 Surface:Nickel plated
 *Screw connection
Rated voltage/current
 30Vac-60Vdc/Max.24A

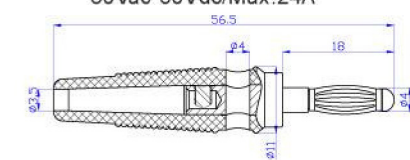

25.402. *



Material
 Insulator:ABS
 Body:Brass
 Spring:Phosphorus copper
 Surface:Nickel plated
 *Solder connection
Rated voltage/current
 30Vac-60Vdc/Max.19A

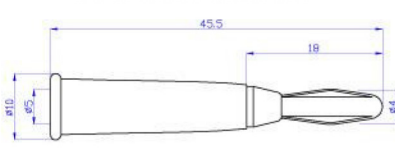

25.412. *



Material
 Insulator:PVC
 Body:Brass
 Spring:Beryllium copper
 Surface:Nickel plated
 *Screw connection
Rated voltage/current
 30Vac-60Vdc/Max.24A

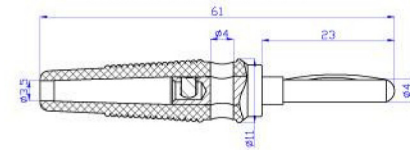

25.403. *



Material
 Insulator:PE
 Body:Brass
 Spring:Beryllium copper
 Surface:Nickel plated
 *Screw connection
Rated voltage/current
 30Vac-60Vdc/Max.32A

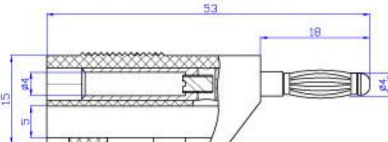

25.413. *



Material
 Insulator:PVC
 Body:Brass
 Spring:Phosphorus copper
 Surface:Nickel plated
 *Screw connection
Rated voltage/current
 30Vac-60Vdc/Max.32A

