

TACT SWITCH

Technical data

- 1.Contact: Mechanical Contact
- 2.Rating: DC 12V 50mA
- 3.Travel: 0.25 0.1m/m
- 4.Operating Force: 160+30gf
- 5.Contact Resistance: 50m Max
- 6.Life: 100.000 Cycles Min

A06-C

- 1.Contact: Mechanical Contact
- 2.Rating: DC 12V 50mA
- 3.Travel: 0.25 0.1m/m
- 4.Operating Force: 160+30gf
- 5.Contact Resistance: 50m Max
- 6.Life:100.000 Cycles Min

| MODELNO | Knob(H) | MODELNO | Knob(H) | MODELNO | Knob(H) |
|-----------|---------|------------|---------|------------|---------|
| A06-A-4.3 | 4.3 | A06-A-9 | 9.0 | A06-C-4.3 | 3.15 |
| A06-A-4.5 | 4.5 | A06-A-9.5 | 9.5 | A06-C-5 | 3.85 |
| A06-A-4.8 | 4.8 | A06-A-10 | 10 | A06-C-6 | 4.85 |
| A06-A-5 | 5.0 | A06-A-11 | 11 | A06-C-7 | 5.85 |
| A06-A-5.5 | 5.5 | A06-A-12 | 12 | A06-C-8 | 6.85 |
| A06-A-6 | 6.0 | A06-A-12.5 | 12.5 | A06-C-9.5 | 8.35 |
| A06-A-6.8 | 6.8 | A06-A-13 | 13 | A06-C-11 | 9.85 |
| A06-A-7 | 7.0 | A06-A-15.3 | 15.3 | A06-C-12 | 10.85 |
| A06-A-7.5 | 7.5 | A06-A-17 | 17 | A06-C-13 | 11.85 |
| A06-A-7.7 | 7.7 | A06-A-20 | 20 | A06-C-15.3 | 14.15 |
| A06-A-8 | 8.0 | A06-A21 | 21 | A06-C-17 | 15.85 |

A07-HL=4.3,5,7.5,10,12,15,18,

- 1.Rating: 12VDC.50mA
- 2.Operating Force: 160+30gf
- 3.Travel:0.3 0.15mm
- 4.Contact Resistance: 100M -2(Max) 100,000cycles
- 5.Operating Temperature: -25-70°C



A06-H

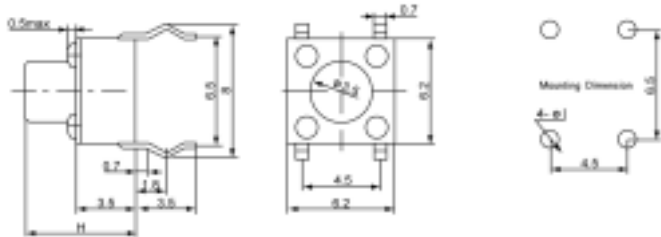

A06-H-A1

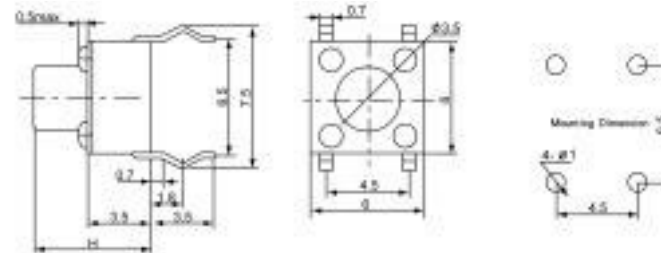

A06-H-A2

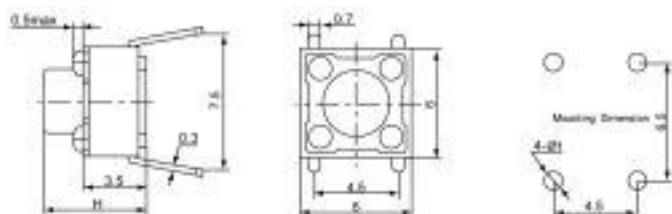

A06-E

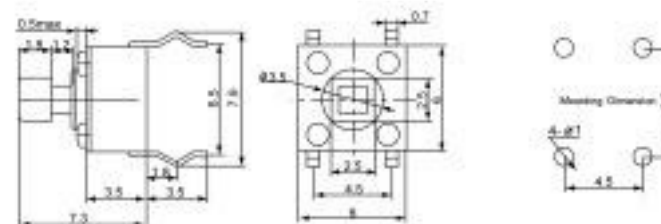



TACT SWITCH



A06-H-B

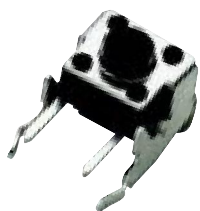
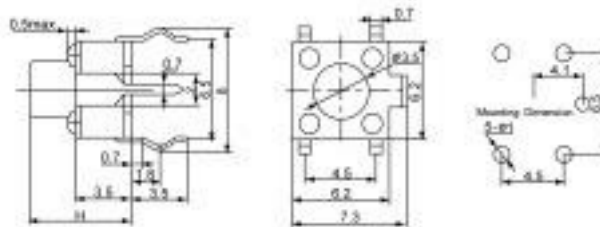

A06-H-C₁

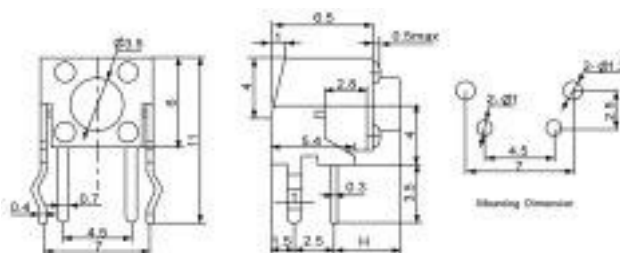

A06-H-T₂

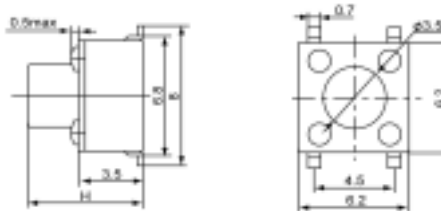

A06-H-T₁

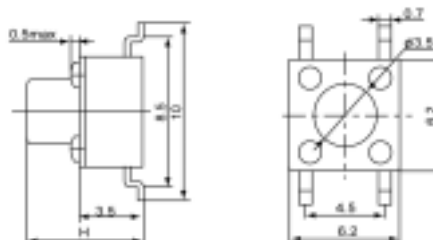

A06-H-T H=2.5,2.7,3.1,3.4

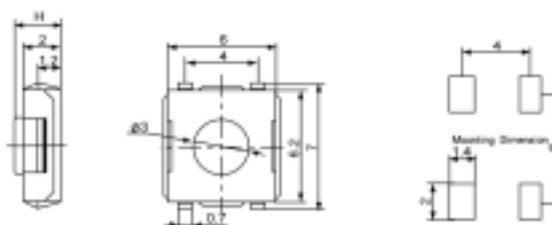

A06-T₁

